



## OUTDOOR SOL-ARK 8K INSTALL GUIDE & OWNER'S MANUAL 1-48

<a href="#"><u>TABLE OF CONTENTS</u></a>	1
<a href="#"><u>DISCLAIMER</u></a>	2
<a href="#"><u>COMPONENT GUIDE</u></a>	3
<a href="#"><u>SYSTEM PLACEMENT</u></a>	4
<a href="#"><u>TRANSFER SWITCH</u></a>	5
<a href="#"><u>MOUNTING</u></a>	6
<a href="#"><u>DIMENSIONS</u></a>	7
<a href="#"><u>BATTERY WIRING</u></a>	8
<a href="#"><u>SOLAR PANEL WIRING</u></a>	9-10
<a href="#"><u>BACKUP GAS GENERATOR SETUP &amp; SENSOR PLACEMENT</u></a>	11
<a href="#"><u>TESTING</u></a>	12
<a href="#"><u>BATTERY SETTINGS AND WIFI SETUP</u></a>	13-21
<a href="#"><u>EMP SUPPRESSOR INSTALLATION</u></a>	22
<a href="#"><u>RAPID SHUTDOWN DIAGRAMS</u></a>	22-23
<a href="#"><u>SPECIFICATIONS</u></a>	24
<a href="#"><u>OFF GRID TIPS &amp; GRID TIE / NO BATT TIPS</u></a>	25
<a href="#"><u>POWERING ON THE SYSTEM / INDICATOR LEDs</u></a>	26
<a href="#"><u>SELECTING POWER MODES / SENSORS</u></a>	26-27
<a href="#"><u>BATTERY SETTING &amp; LIMITER SENSOR AUTO-SETUP</u></a>	28
<a href="#"><u>SCREENS (GUI MAP PAGE 36)</u></a>	29-35
<a href="#"><u>BATTERY CHARGE/DISCHARGE REFERENCE</u></a>	36
<a href="#"><u>TROUBLESHOOTING GUIDE / ERROR CODES</u></a>	37-39
<a href="#"><u>COMMON BATTERY APPLICATION NOTE</u></a>	39-40
<a href="#"><u>WIRE GAUGE GUIDE</u></a>	41
<a href="#"><u>COMPATIBILITY REFERENCE GUIDE</u></a>	42
<a href="#"><u>MODBUS/RS485 PIN OUT AND REGISTERS + TORQUE VALUES</u></a>	43
<a href="#"><u>SYSTEM WIRE DIAGRAMS</u></a>	44-46
<a href="#"><u>INSTALL TESTING CHECKLIST</u></a>	47
<a href="#"><u>WARRANTY</u></a>	48

**Outdoor**

### CONTACT US

PHONE

EMAIL

WEBSITE

**Outdoor**

1-972-575-8875 x2

SUPPORT@SOL-ARK.COM

WWW.SOL-ARK.COM



## Disclaimer

UNLESS SPECIFICALLY AGREED TO IN WRITING, SOL-ARK:

(a) MAKES NO WARRANTY AS TO THE ACCURACY, SUFFICIENCY OR SUITABILITY OF ANY TECHNICAL OR OTHER INFORMATION PROVIDED IN ITS MANUALS OR OTHER DOCUMENTATION.

(b) ASSUMES NO RESPONSIBILITY OR LIABILITY FOR LOSS OR DAMAGE, WHETHER DIRECT, INDIRECT, CONSEQUENTIAL, OR INCIDENTAL, WHICH MIGHT ARISE OUT OF THE USE OF SUCH INFORMATION. THE USE OF ANY SUCH INFORMATION WILL BE ENTIRELY AT THE USER'S RISK.

Sol-Ark cannot be responsible for system failure, damages, or injury resulting from improper installation of their products.

Information included in this manual is subject to change without notice.

Sol-Ark 8k inverter should be installed by qualified persons only.

This version is for **OUTDOOR MODELS ONLY**, previous hardware versions of the Sol-Ark 8k are not compatible with the wire diagrams and instructions contained herein.



**System Must Have Ground**  
**System Must Have Neutral**  
**Solar PV+/PV- Are Ungrounded**  
**Ground Must be Bonded to**  
**Neutral Once in Circuit**

## 1. Inspect Shipment

- a. Compare the package condition to the condition of the package in the photo we sent you before it left our facility. **You must note any damage due to shipping with delivery driver before accepting the package otherwise the shipping company will deny any claim.**
- b. If damaged, contact us immediately at 972-575-8875 Ext. 3

## 2. Component Guide

- a. Limiter Sensors included: 5/8" CT sensors x2
- b. Limiter Sensors if purchased: 15/16" CT sensors x2
- c. Limiter Sensors if purchased: 2" CT sensors x2
- d. Battery Temperature Sensor: for voltage adjustment
- e. Battery Cable Toroid x2
- f. WIFI Plug: For software updates and remote monitoring (use screws to hold in!)
- g. Allen Key: for opening the user area of the system
- h. French Cleat: For wall mounting the Sol-Ark 8k

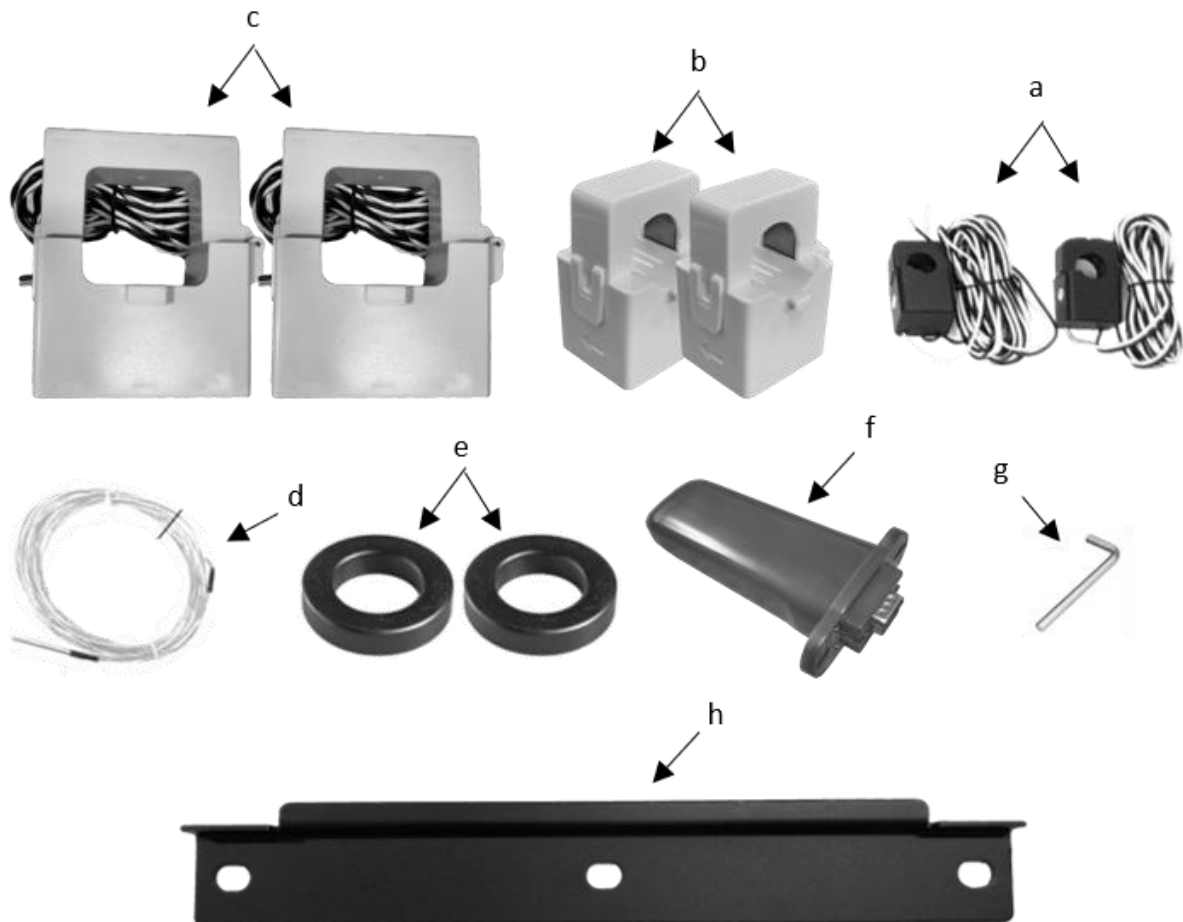

### 3. Component Distance Guide

WIRE RUN LENGTH: SEE DIAGRAM FOR WIRE GAUGE (AWG) RECOMMENDATIONS, PAGE 43 FOR COMPLETE DETAIL

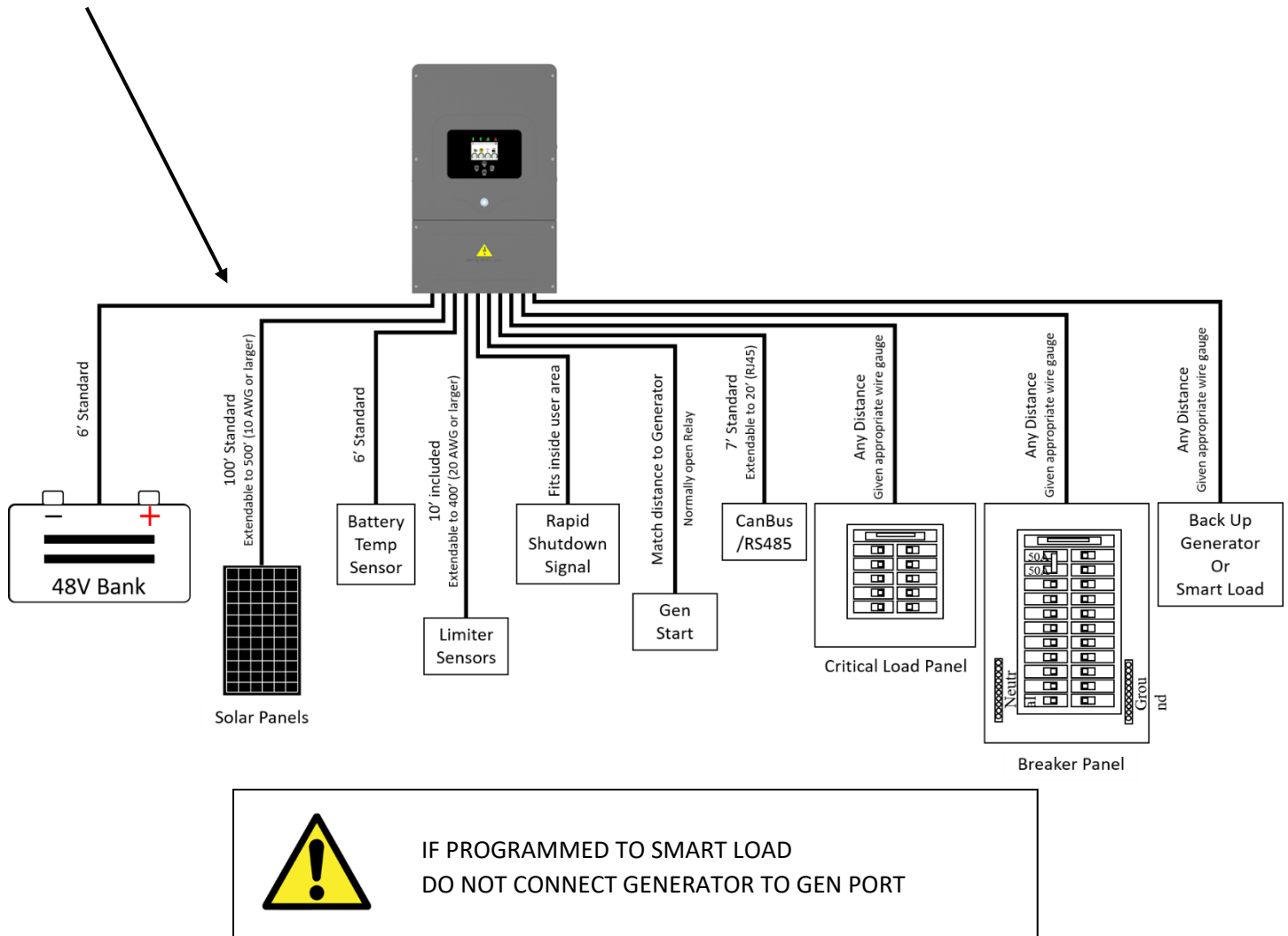

### 4. Decide Critical Backup Circuits

- Subpanels are recommended and are required if you have **Arc-Fault / GFI** breakers.
- Important: Make sure to keep within inverter amperage limits** (per inverter):  
On Grid = 63A continuous (pass-through)  
Off Grid = 33.3A continuous/83A peak
- Verify each load circuit by measuring typical and max Amps with a clip-on Amp meter. Amps x 120V = Watts
- If you have Arc-Fault / GFI breakers in your main panel we recommend that you install a subpanel for your backup loads, not a multi-circuit transfer switch.**

## 5. Mount Multi-Circuit Transfer Switch (Not valid for Arc-Fault/GFI breakers) OR Critical Loads Panel

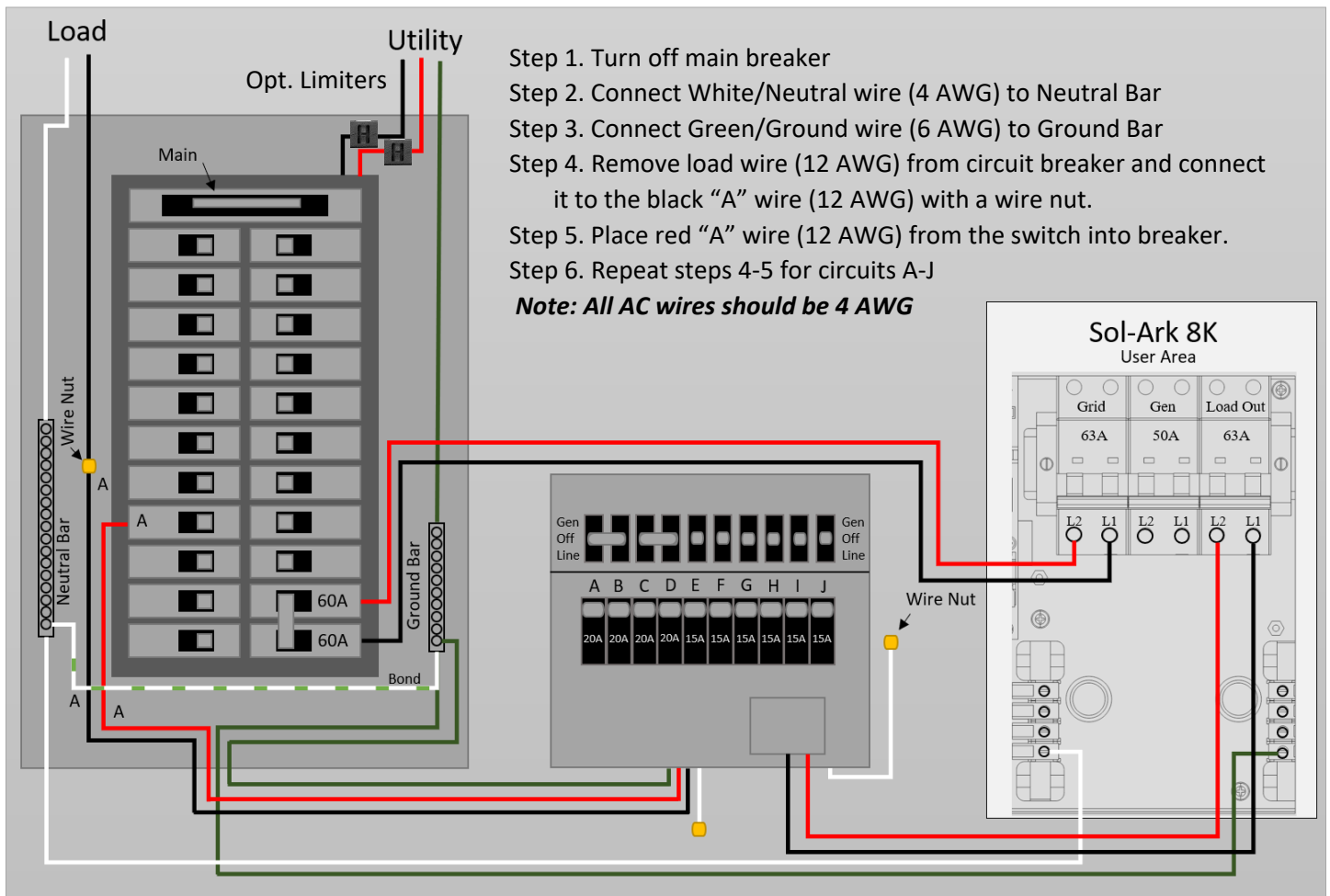

### **Important notes:**

When the transfer switch is in the "Gen" position, this means the circuit is being powered by the Sol-Ark (which can use Grid/Solar/Battery/Generator automatically).

When in the "Line" position, the transfer switch is being powered by the grid (Sol-Ark can be removed).

The transfer switch setup is complete once all the switches are set to "Gen" position.

The Sol-Ark will take care of the rest.

If you are not installing a transfer switch (Off Grid or have a 50A sub-load panel), you can wire the "Load" output of the Sol-Ark 8k directly to a Main Lug breakers sub-panel rated for at least 50A.

**Please refer to diagrams section for complete wire diagram**



**Strain Reliefs must be used for all wires going in/out of the Sol-Ark 8k user area**

**Ground and Neutral must be wired as shown above, or damage can occur.**

**Conduit (or double insulated wire) must be used for the AC Wires going to and from the Sol-Ark.**

**DO NOT CONNECT THE GRID TO THE LOAD OUTPUT BREAKER**

## 6. Single System Installs: Install Double Pole 60A breaker in Main Panel for Grid In/Out

- It is best practice to install at the opposite end of the bus bar from the main breaker (Usually this is the bottom of the breaker panel as seen on page 5).

## 7. Mount Sol-Ark 8k

- Find a suitable location for the system(s), keeping in mind the dimensions in Fig. 1 below.
- While the Sol-Ark 8k does not yet have an official NEMA rating for outdoor use, you can install the system outside and the warranty will be honored.
- LCD screen should be protected from excessive UV exposure.**
- The system weighs 78lbs (35kg), be sure to attach it securely to the wall. You may need to affix a mounting board to your wall first using 6-8 screws into studs.
- Then use 2-3 screws (appropriate in length and type for your mounting surface) to mount the French Cleat to the board/wall (washers recommended).
- Mount the Sol-Ark on the installed cleat making sure that it sits properly and is level.
- Add 2 screws in bottom mounts.

### Sensor Pin Out (Located in Sol-Ark user area)

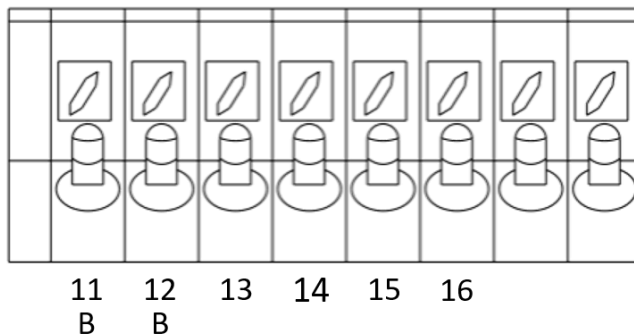

**(1,2) Batt Temp:** Battery Temperature Sensor has no polarity and is needed for voltage correction when using lead acid batteries.

**(+3, -4) CT1 & (+5,-6) CT2:** Current transformers used for limited to home mode and peak shaving

**(7,8) Gen Start Relay:** Two wire start for generators, simple open or closed relay

**(9,10) Gen On Relay:** Not currently used

**(B 11, B 12) Emergency Stop:** Short these pins to initiate emergency stop. This will shutdown AC output from the inverter and initiate rapid shutdown of the PV.

**(+13, -14) Optional 12V input signal** for RSD

**(+15, -16) 12V power supply** for RSD transmitters: such as TIGO and Midnite

Rated for a **maximum of 1.2W (100mA @12V)**

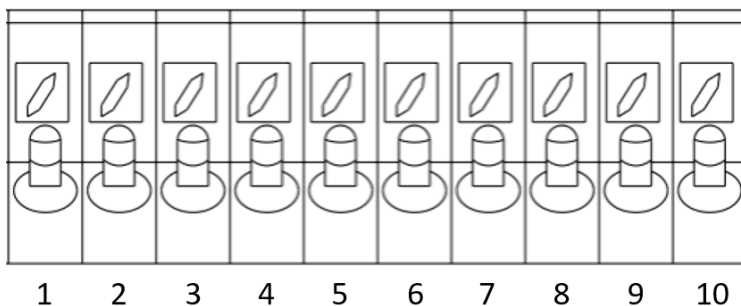
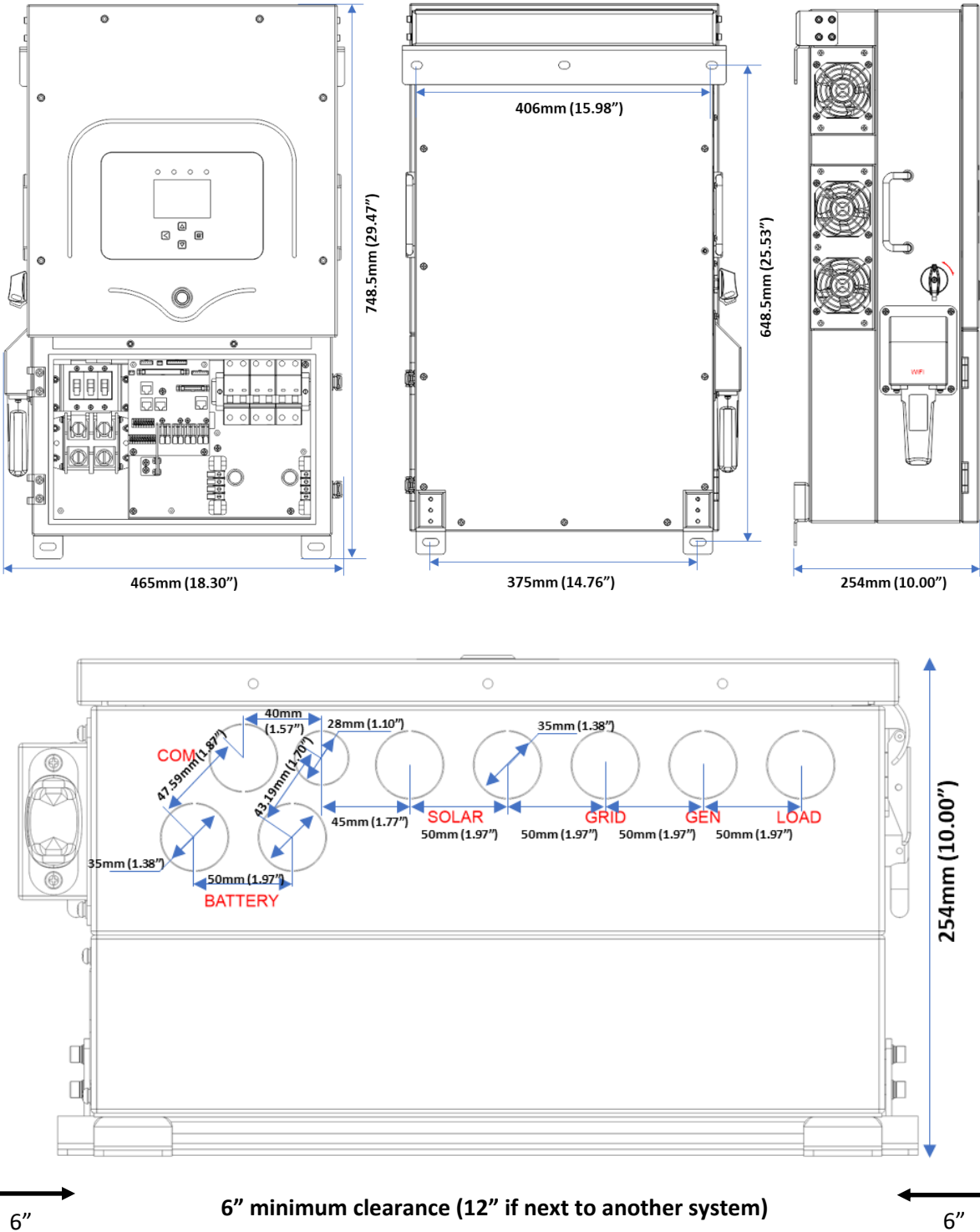

Fig. 1



## 8. Connect Batteries (Sol-Ark should be POWERED "OFF")

- Connect the batteries to the Sol-Ark 8k as shown in the diagrams **Fig. B** below:
- Fig. A: Install included ferrites (**part k. on pg. 3**) on the battery input cables. Slide the ferrite over the battery cables so that both cables are within the toroid (as shown in Fig. A).
- When connecting batteries make sure the built-in battery disconnect is in the off position while the batteries are connected, or arcing will occur.

**Fig. A**



**Fig. B**

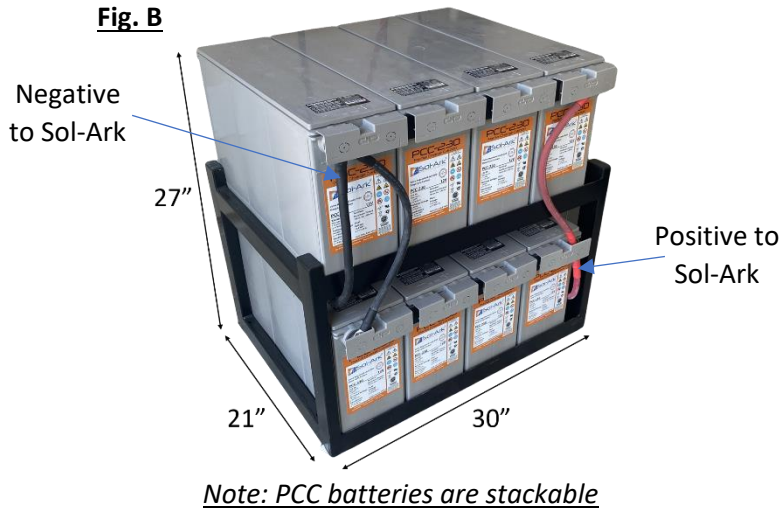

**Sol-Ark PCC-230 16 Rack**

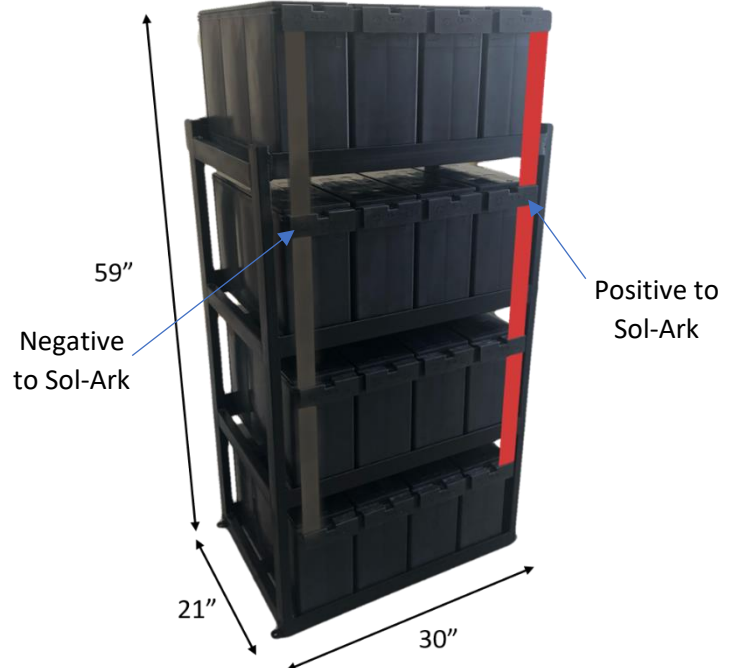

**WARNING! Do not stack more than 2 banks high!**

Sol-Ark 8k is a **48V** system. Do not wire the battery bank to any other nominal voltage. When using 12V batteries do not exceed 4 batteries in series. When using other battery chemistries, stay within the voltage range: Min 43V-Max 63V

**Fig. C**

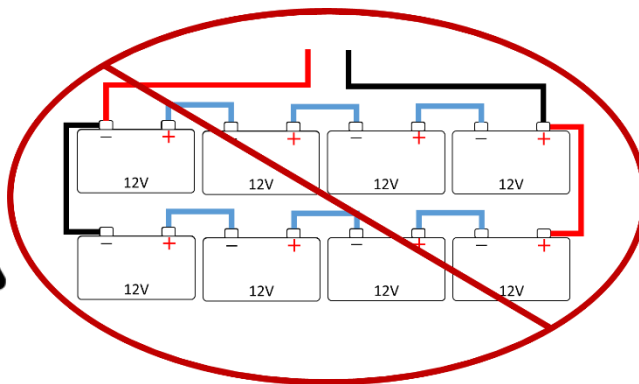

**Do NOT reverse  
polarity of batteries!  
Damage will occur!**

## 9. Solar Panel Install

- Sol-Ark 8k has 2 separate pairs of solar panel inputs. (**Dual MPPT**)
- 
- Max PV input:



11,000W(+/- 5%) per system (5,500W per MPPT) PV = 500Voc Max

Max Isc input per MPPT: 25A (self-limiting to 18A @ 500Voc/400Vmp)

**Note: Damage will occur if PV Voc > 550V.**

4. Connect the strings of solar panels to the system as shown on pages 9/10.

5. Parallel strings per MPPT must be the same voltage, PV1A/B must be the same voltage if both are used (see Fig. E). It is OK if panels for panels on the same MPPT to face different directions.

6. Panel frame grounding can be done to any ground in the home via 12AWG wire. Mounts usually bond frames together, so only 1 ground wire is needed.

**Note: Max Panels in Series** (Rule of Thumb, always verify the string characteristics are within spec):

**60 Cell: 10**

**72 Cell: 9**

**96 Cell: 6**

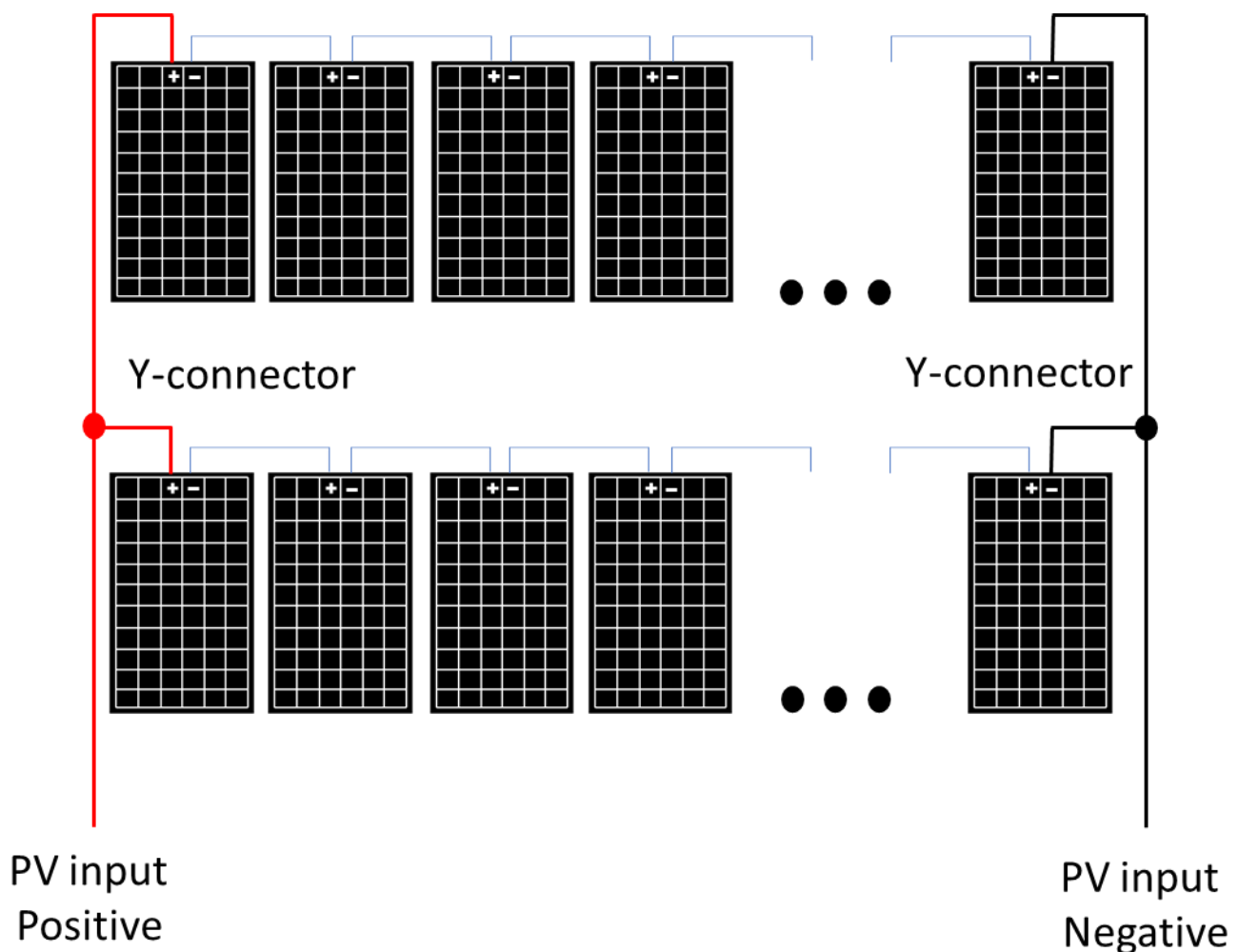

**If using Y-Connectors:** (Running two strings in parallel, totaling 20A (self-limiting) Note: separate wires can be used per string, and string minimum is usually 5 panels or 175V)

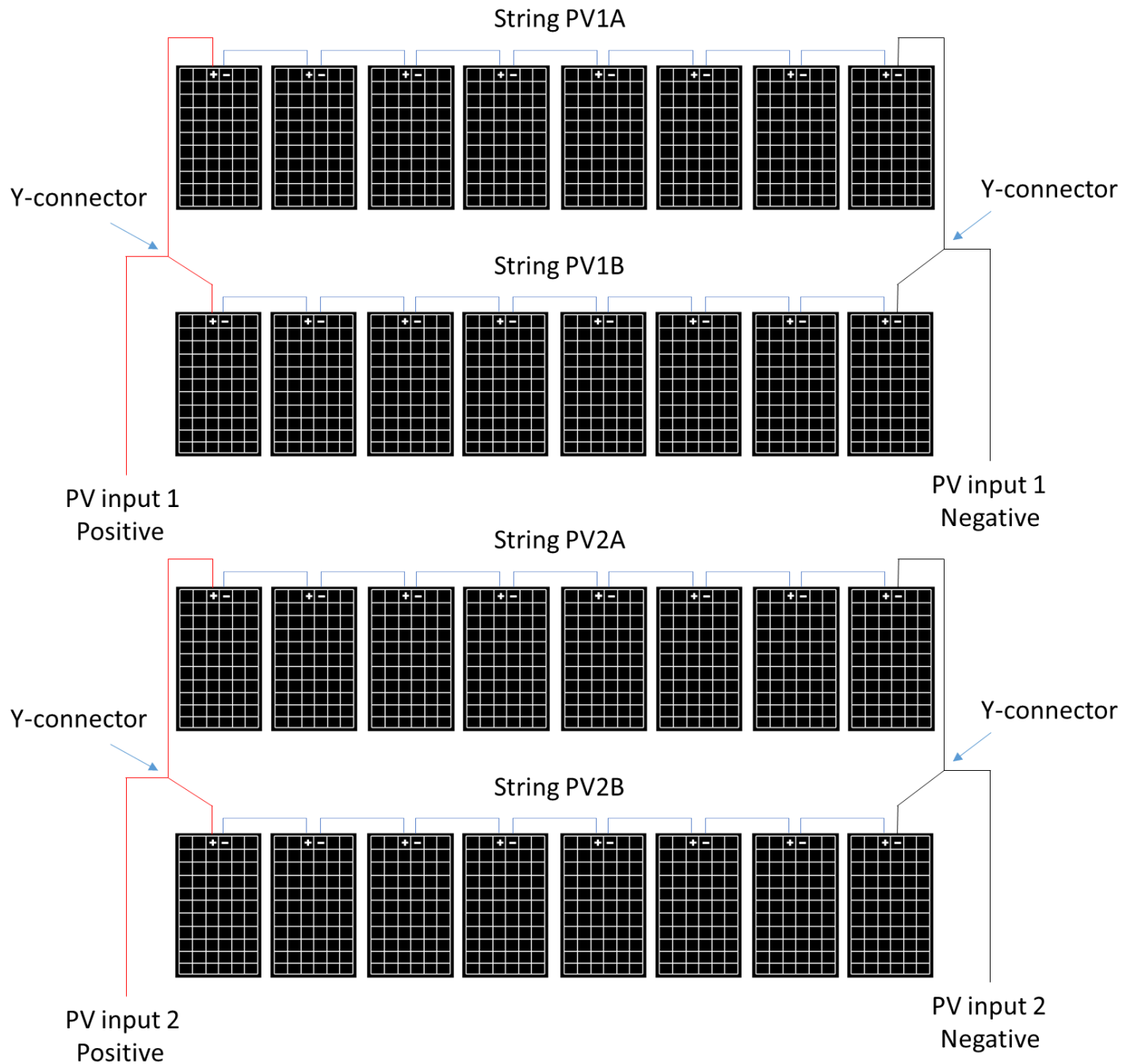

## 10. Connecting a Generator (240V/208V only)

- a. Generators smaller than 10kW - See diagram 1
  - i. Connect the generator output to the “Gen” input breaker in the Sol-Ark 8k user panel.
  - ii. Only 240V/208V generators are supported.
  - iii. THD of less than 15% preferred but not required.
  - iv. **If you have AC coupled solar panels and a generator then you must use the TOU setting to prevent the generator from being called for during the daytime or else damage will occur. Simply uncheck the “charge” checkbox for time slots that may have PV production.**
  - v. If **Off-Grid**, connect the generator output to the “Grid” input in the Sol-Ark and select the “GEN connected to Grid input” option in the Sell Control tab of the Grid Setup Menu.
    1. Home Screen → Gear Icon → Grid Setup → Sell Control
  - vi. Gen peak shaving mode is used to prevent the Sol-Ark from overloading small generators. The CT sensors must be placed so that they measure L1 and L2 of the generators output and the arrows on the CTs will point toward the generator. The “Power” value is the threshold at which the Sol-Ark will contribute and prevent the generator from being overloaded. This mode will auto adjust the gen charge amperage to prevent overload.
- b. Standby Generators >10kW - See diagram 3
  - i. If **Off-Grid**, you may connect the generator output directly to the “Grid” input on the Sol-Ark 8k. The Sol-Ark 8k will perceive the generator as if it were the grid. You will need to select the “GEN connected to Grid input” option in the Sell Control tab of the Grid Setup Menu.
    1. Home Screen → Gear Icon → Grid Setup → Sell Control
  - ii. **If you have AC coupled solar panels and a generator then you must use the TOU setting to prevent the generator from being called for during the daytime or else damage will occur. Simply uncheck the “charge” checkbox for time slots that may have PV production.**
  - iii. Being **Off-Grid**, you will have “Grid Sell” off and will only need CT sensors if you plan to use Gen peak shaving mode. See description above.
  - iv. To make your generator work better with the Sol-Ark: Under “Grid Setup” do the following:
    1. Select “Limited to Load”
    2. Select “General Standard”
    3. Increase Grid frequency range: 55-65Hz
  - v. If using a large generator with a whole home transfer switch, we suggest not using the “Gen” input breakers in the Sol-Ark. Instead, use the existing home wiring to distribute the generator’s power (through your existing “Gen” transfer switch, usually to the main panel in the home or building).

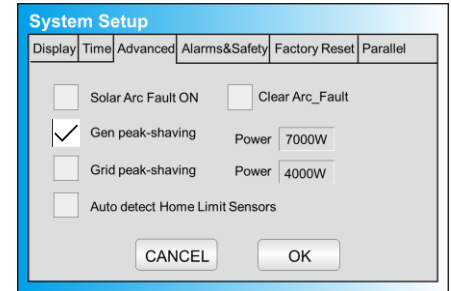

## 11. Sensor and Accessory Placement

- a. Limiter Sensors (CT Sensors)
  - i. Install on incoming electrical service wires on L1 and L2 (see diagram pg. 11). Required if in Limited To Home Mode (meter zero) and Peak Shaving. Please check your wire size before ordering to ensure the sensors will fit.
- b. Battery Temp Sensor
  - i. Place between batteries, tape is a common mounting method. (See Fig. F). Note: Temp sensor is not required for lithium batteries. This sensor has no polarity when connecting to the sensor input of the Sol-Ark.
- c. CanBus & RS485

**Fig. F**

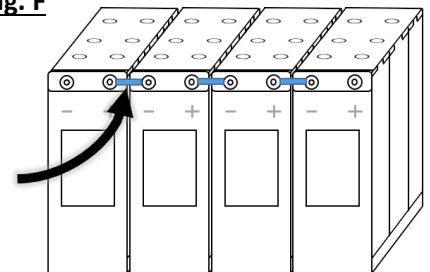

- i. To connect batteries to the Sol-Ark 8k via RJ45, you will need to splice the end that connects to the Sol-Ark 8k. Use the middle two conductors.
  - ii. RS485 is SunSpec draft 4 (will not work with draft 3)
- d. Gen Start Signal (Two-Wire)
  - i. Normally open relay that closes when the Gen Start state is active
  - ii. If your generator only starts with the loss of 120/240V to the generator, we suggest using a DPST relay to the output of the inverter.
- e. PV Rapid Shutdown Signal
  - i. 12v signal/200mA power is present until the Sol-Ark is shut down with the front button
- f. Emergency Stop Signal
  - i. Use a normally open switch to connect the two emergency stop pins, when triggered, the RSD power supply will be cut and the inverter AC output will be stopped.
- g. WI-FI Antenna
  - i. Needed for remote monitoring and/or software updates.

## 12. Testing and Powering up Sol-Ark 8k

- a. Check Voltage of each PV input circuit
  - i. Should be no higher than 500Vdc open circuit temperature corrected.
  - ii. **DO NOT connect PV+ OR PV- to GND.**
  - iii. Good to verify polarity (if polarity is backwards the Sol-Ark will show a Voltage of 0V).
- b. Check Grid Input Voltage (voltages shown are for North America)
  - i. Ensure 120Vac L1 to Neutral and L2 to Neutral.
  - ii. Ensure 240Vac L1 and L2.
  - iii. Check Neutral and Ground are ~0V AC.
- c. Check Battery voltage
  - i. Turn on battery switch (if using a Lithium battery).
  - ii. Turn on the built-in battery disconnect in the user area of the Sol-Ark.
  - iii. Voltage should be 45Vdc-60Vdc.
- d. If all checks out, Turn on Breakers for Grid and Load, Turn PV Disconnect knob to "On"
  - i. Note: (If PV is backwards: Sol-Ark will show a voltage of 0 for PV)
- e. System will boot up with power from PV, Grid, or ON/Off Batt.
- f. Press the ON/OFF Button on the front, light should come on.
- g. If you installed limit sensors for Limited To Home selling mode, it is critical you verify the proper sensor placement and direction. (Auto learn function avoids this section if not 208V, function can be found under the advanced tab of the basic setup menu in settings).
  - i. Using AC multi-meter, verify L1 voltage on AC in/out is 0Vac with main L1 connection in panel. Same for L2.
  - ii. To verify sensor connections to Sol-Ark, try removing one sensor from the main L1 connection. The power should drop to 0W.
  - iii. To verify proper sensor direction, with any loads in the home, the HM: +watts will be positive. If you turn on solar panels and turn enable Grid Sell, you should see HM: -watts if you are producing more power than the loads are consuming. And if you turn on limited power to Home mode, then HM: ~0 watts to zero the meter (system matches the loads to within 99%).

## 13. Basic Setup

- a. Display: Auto dim must be enabled for LCD screen to be covered by warranty. Color LCD screens dim if left on continuously for years.
- b. Time: Set date and time for the system

## 14. Programming Battery Settings

- a. Battery Capacity
  - i. This allows Sol-Ark to know the size of the battery bank. The system is also self-learning as batteries age.
  - ii. Main Menu → System Settings → Battery Setup → Batt → Batt Capacity
- b. Use Battery Voltage or % Charged
  - i. Use whatever you are comfortable with. Most installers prefer voltage, while most homeowners prefer % Charged. (Note: if Lithium BMS is selected but not present, Sol-Ark will force Voltage mode)
- c. Battery Charge & Discharge Current
  - i. For a list of settings for commonly used batteries see the application note section of this manual.
  - ii. For AGM and Flooded, we recommend Ah battery size x 20% = Charge/Discharge amps
  - iii. For Lithium, we recommend Ah battery size x 50% = Charge/Discharge amps
  - iv. For Gel, follow manufacturer's instructions.
  - v. When Off Grid, The Sol-Ark will shut down if Max discharge current is exceeded for 10 seconds.
- d. Battery Type
  - i. Navigate to the charge menu and set the values appropriate to your battery chemistry. The owner's manual is good reference for lead acid batteries.
  - ii. Main Menu → System Settings → Battery Setup → Charge
- e. Supported Battery Chemistries (48V configuration required for all chemistries)
  - i. Lead Acid
    - AGM, Gel, Wet
  - ii. Lithium
    - NMC, LiPo4
  - iii. NiFe (Note: must use a 37 series cell configuration, 44.4V Nominal)
    - Set Absorb and Equalization to 61.0V, 3 hours, and days = 1 (every day). Float = 53.7V

Battery Type	Absorption Stage	Float Stage	Equalize Stage (every 30 days 3hr)
AGM (or PCC)	14.4v (57.6v)	13.5v (53.6v)	14.4v (57.6v)
Gel	14.1v (56.4v)	13.5v (54.0v)	
Wet	14.7v (59.0v)	13.7v (55.0V)	14.7v (59.0v)
Lithium	14.1v (54.6v)	13.2v (54.3v)	14.1v (54.6v)

AGM Default

- f. Battery Discharge
  - i. Allows the user to define the depth of discharge the system will allow before using the grid/generator to charge the battery bank. Solar is always the priority in charging the battery bank.
  - ii. Main Menu → System Settings → Battery Setup → Discharge

## 15. Grid Setup

- a. Grid Sell: maximum watts sold to grid
- b. Limited To Home: Limits power produced by the system to match the demand of the home
- c. Limited To Load: Limits power produced by the system to match the demand of connected loads
- d. Time of Use: Use battery power to support the programmed mode at selectable times/watts/DoD

## 16. Remote Monitoring Setup

- a. Ethernet Dongle
  - i. Open Dongle housing
  - ii. Thread ethernet cable through provided opening and plug into the RJ45 port
  - iii. Reassemble the dongle housing
  - iv. Plug dongle into Sol-Ark and secure with screws
  - v. If all is well, you will see solid red and green lights
  - vi. Register your dongle via the app or [www.mysol-ark.com](http://www.mysol-ark.com)
- b. WIFI (Via Cell Phone or computer)
  - i. Plug WIFI dongle into Sol-Ark
  - ii. Using your device look for WIFI networks and select the one that matches the S/N number on your dongle or the one that starts with “EAP” or “E470-####-####”
    - Password: 12345678
  - iii. Once Connected to the Dongle
    - Follow this instruction on the following pages

Once Setup is complete, Dongle will have a solid green LED and a solid Red light

## WiFi Setup (Video: <https://youtu.be/99qoz8jHswA>) w/Phone App

### 1. Download the App:

  <p>iPhone: <a href="https://apps.apple.com/us/app/powerview-es/id1460941008">https://apps.apple.com/us/app/powerview-es/id1460941008</a></p>	 <p>Android: <a href="https://play.google.com/store/apps/details?id=com.elinter.app.ups">https://play.google.com/store/apps/details?id=com.elinter.app.ups</a></p>
--	---

### 2. Open App

### 3. Create an Account (Installers Please See Note)

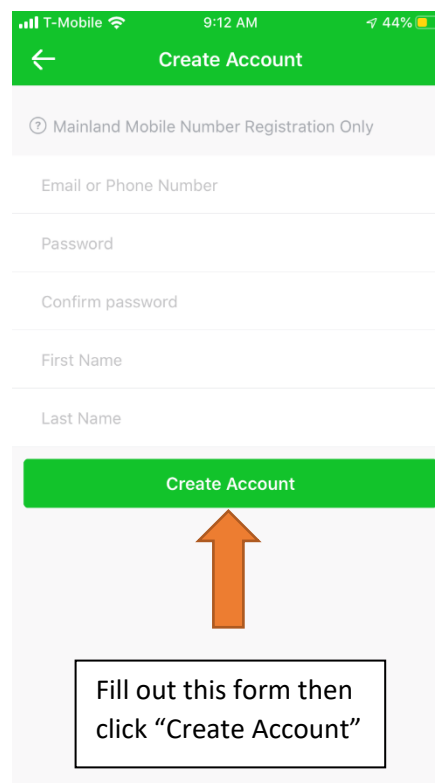
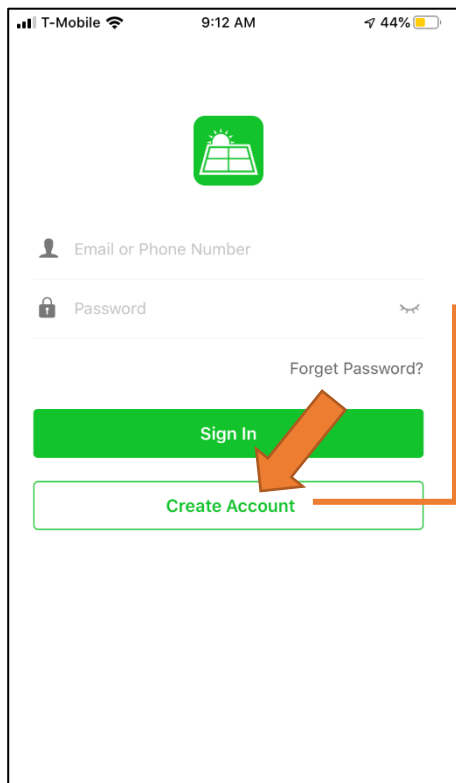



**Attention Installers**

If you plan to add an install to your installer account for monitoring multiple installs, you must first make your installer account. Then before the customer makes their account, add the WiFi dongle to your account. Each customer must have their own account and each Sol-Ark must have its own Plant in the software.

## 4. Sign in

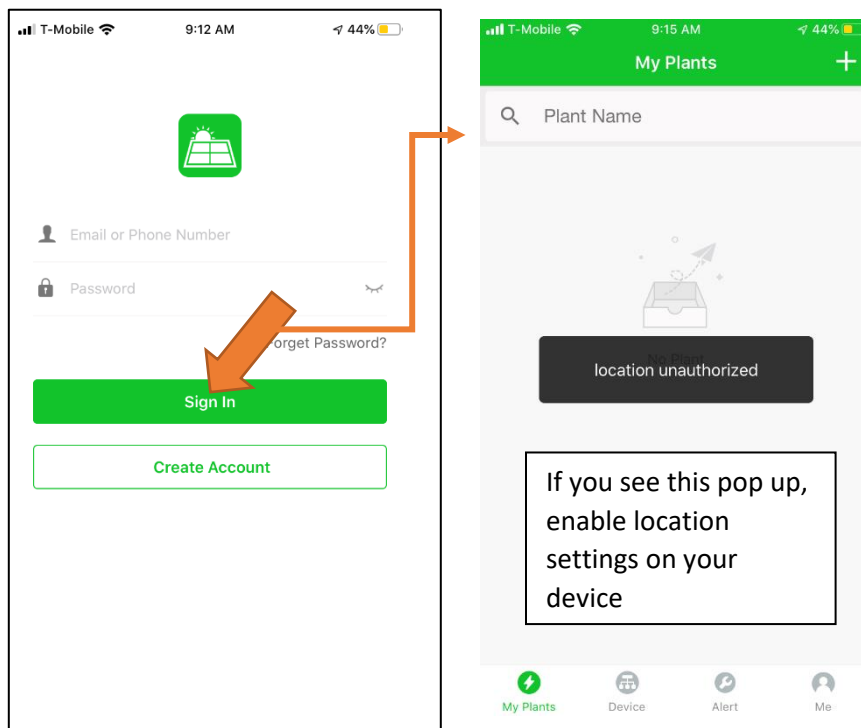

## 5. Add a Plant

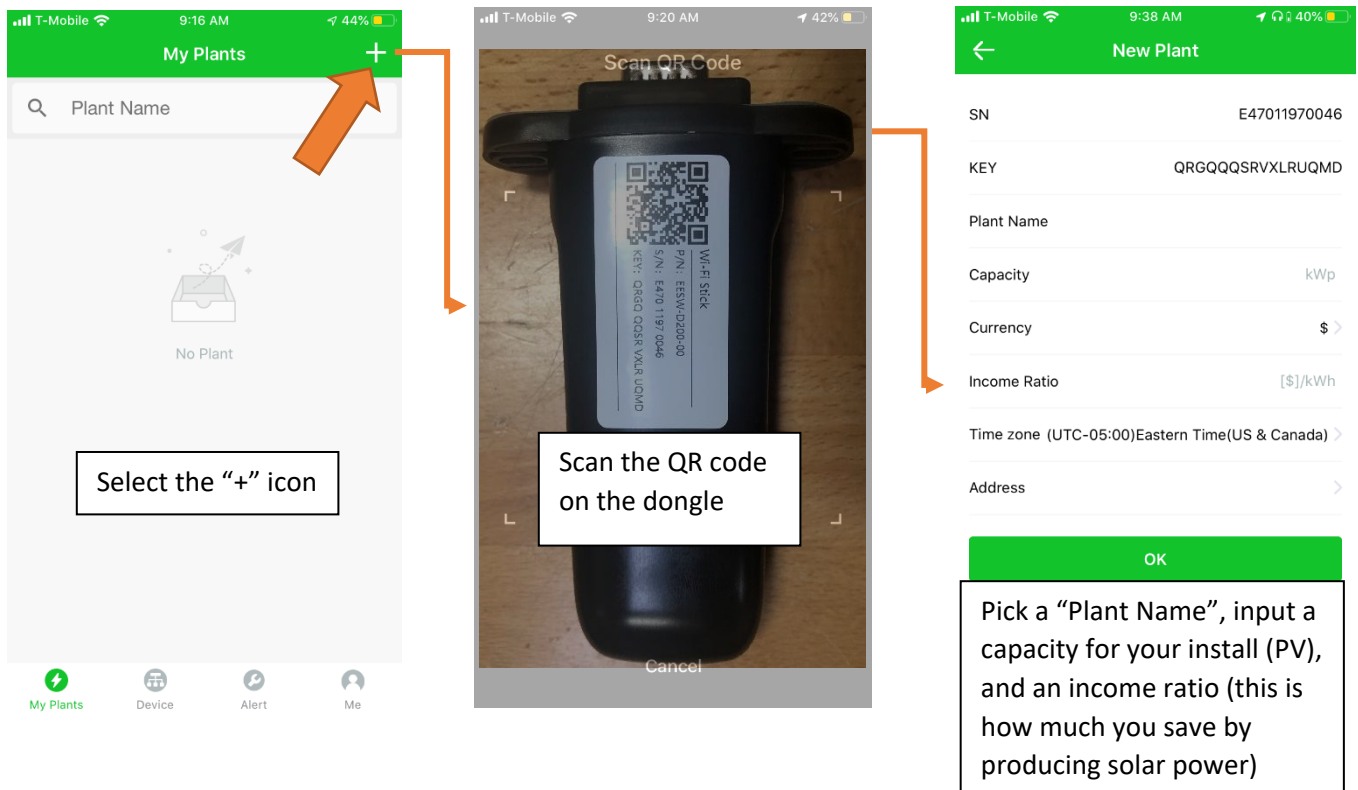



## 6. Connect your system to the internet

**My Plants**

Plant Name

Test

Power 0W Today Generation 0kWh

offline

**Me**

First Last  
dustin@sol-ark.com

Change Password

Tools

Language

About Us

Logout

**Tools**

Common tools

Find device

Scan QR

Select "Find device"

Select "Tools"

Select the "me" icon

**Config Device**

12:00 100%

WLAN

WLAN

EAP-test

Please select wireless network with prefix "EAP-" in "Settings - Wireless LAN" of the phone and return to this page when the connection is successful.

GO SETTING

**Connect To Router**

This device has connected to : TP-LINK\_735E

SSID pls\_select

Password

confirm

Select "Pls\_select"

Once you see this screen go to your devices WiFi setting and connect to the WiFi network that starts with:

EAP-#####

Password: "12345678"

Once connected return to the app

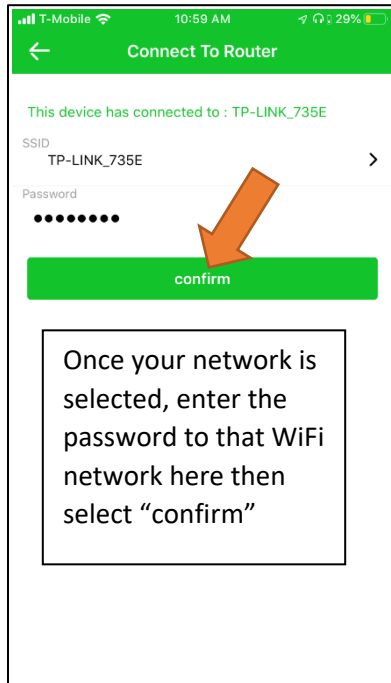
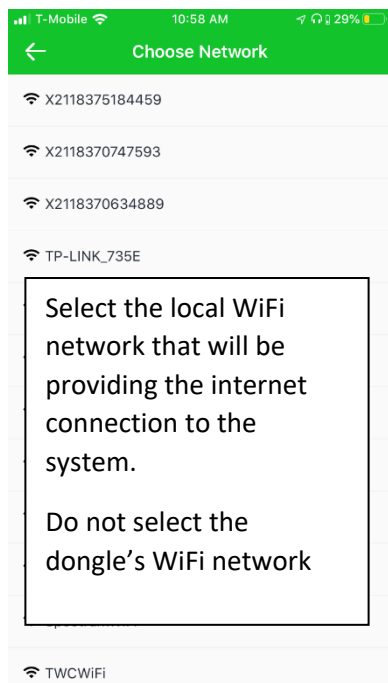

It takes about 60sec for the lights to turn on after setup.

Red LED: Connected to Sol-Ark and has power.

Green LED: Connected to Internet and Server

Flashing Green LED: Connected to router but not server (usually a VPN or firewall issue)

## 7. Start Monitoring

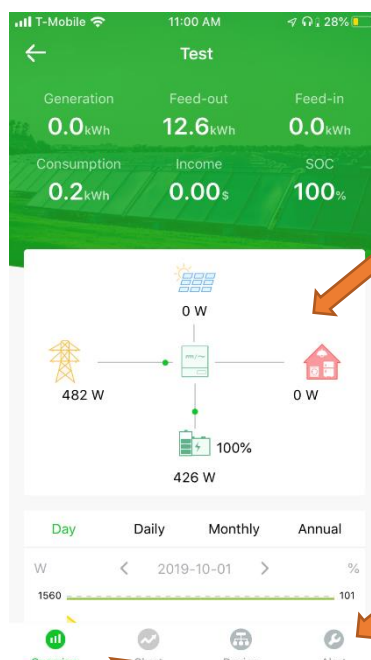
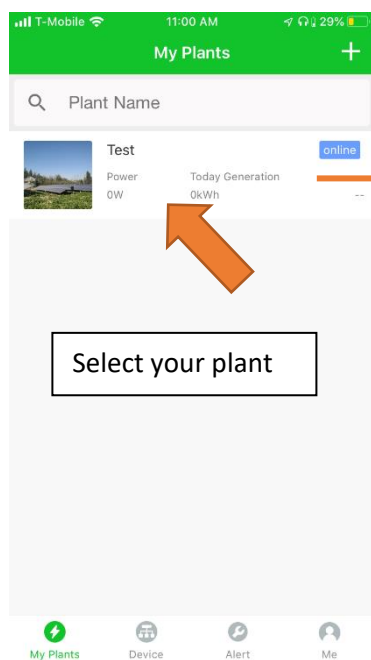

This screen is the real time view

Alarms

Graphed data

System info and programming

## IP Address Setup Instructions (PC or Smart Phone)

Please Note that this method only achieves internet connectivity, for registration and account management please use the app and/or

[www.mysol-ark.com](http://www.mysol-ark.com)

### 1. Connect to the Dongle:

- Settings → Wi-Fi → Select the Network with E##### (The last 5 digits of your SN number)

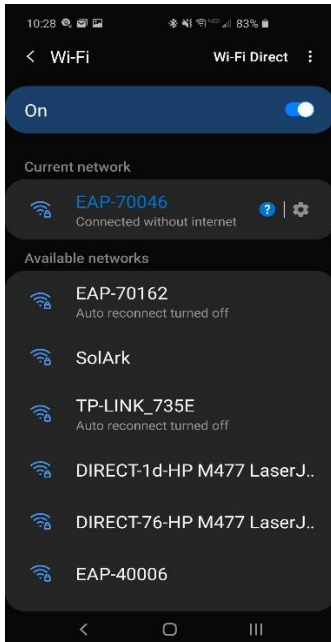

Password: 12345678

\*Disclaimer: The wi-fi dongle does not have internet, you still need to be connected to the dongle for this process.

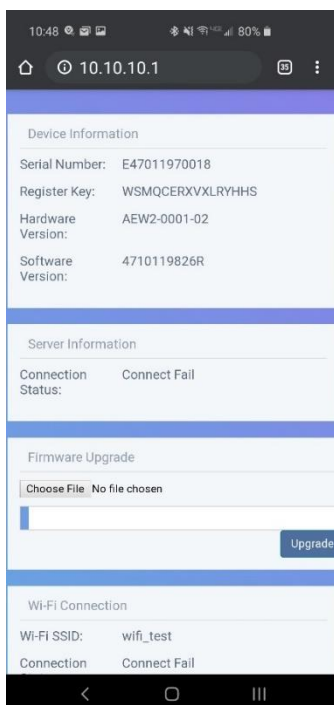

### 1. Login to Web Portal using any search browser:

- Open Google or Safari → type in the search bar 10.10.10.1

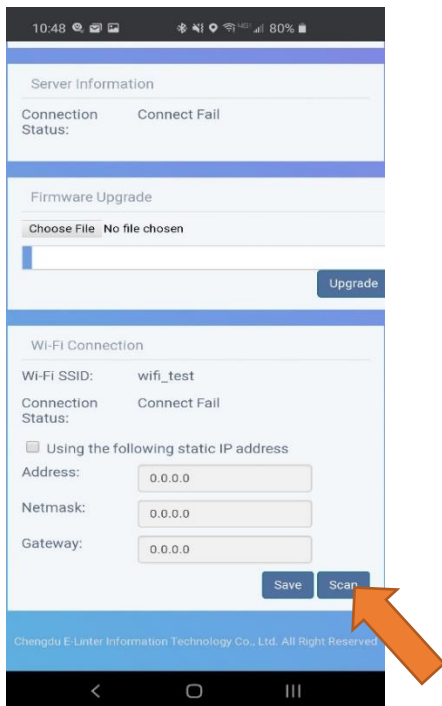

### 3. Scroll Down until you see Wi-Fi Connection:

- b. Once you see the Wi-Fi connection settings, select the Scan button to search local area networks.



### 4. You will see several networks; choose the home network (Not the dongle's network).

\*Disclaimer: Connecting the dongle via the IP address only connects the dongle to the internet.

**\*YOU MUST STILL CREATE AN ACCOUT VIA THE POWER VIEW APP.**

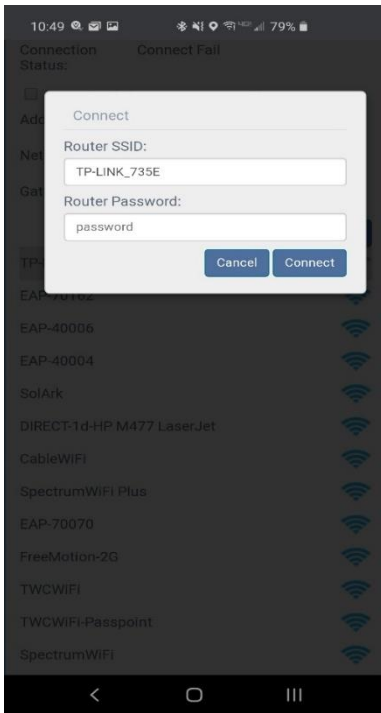

5. Enter in the Password for your Network and select Ok
  - c. Select Network → Enter in Password → Select Connect

## 2. Once Password is Entered, tap the “Save” button underneath the Wi-Fi Information

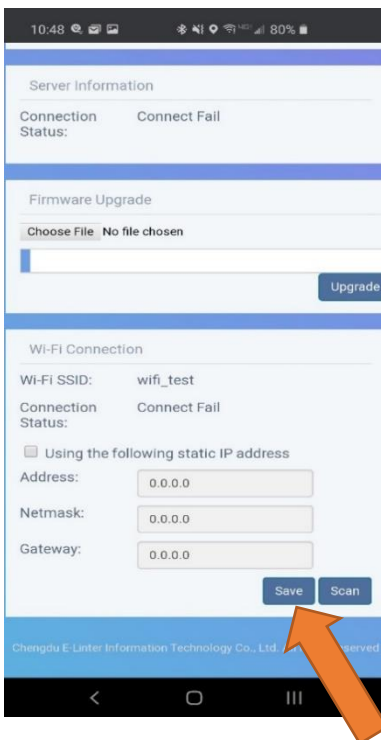

If Successful you should get a Red and Green light on the Dongle showing that it is connected.

Red LED: Connected to Sol-Ark and has power.

Green LED: Connected to Internet and Server

Flashing Green LED: Connected to router but not server (usually a VPN or firewall issue)



## E.M.P Systems only:

### Suppressor installation

- If your system was purchased with Lightning / EMP Hardening, the vast majority of protection is in the Sol-Ark. However, you also have EMP suppressors that get installed on the power cords of appliances that are connected to the transfer switch. Although not critical, it is recommended they be installed as close as possible to the appliance.
- You also have EMP suppressors that get installed on both solar panel wires with a zip tie. Closer to the panel is better. If you purchased the panels from us, we already installed >150kV/m protection inside the solar panels.

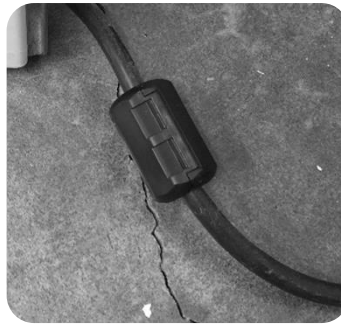

**If using panels not  
from Sol-Ark**

### Emergency Stop Diagram (Only available on select hardware versions & Shown with TIGO TS4)

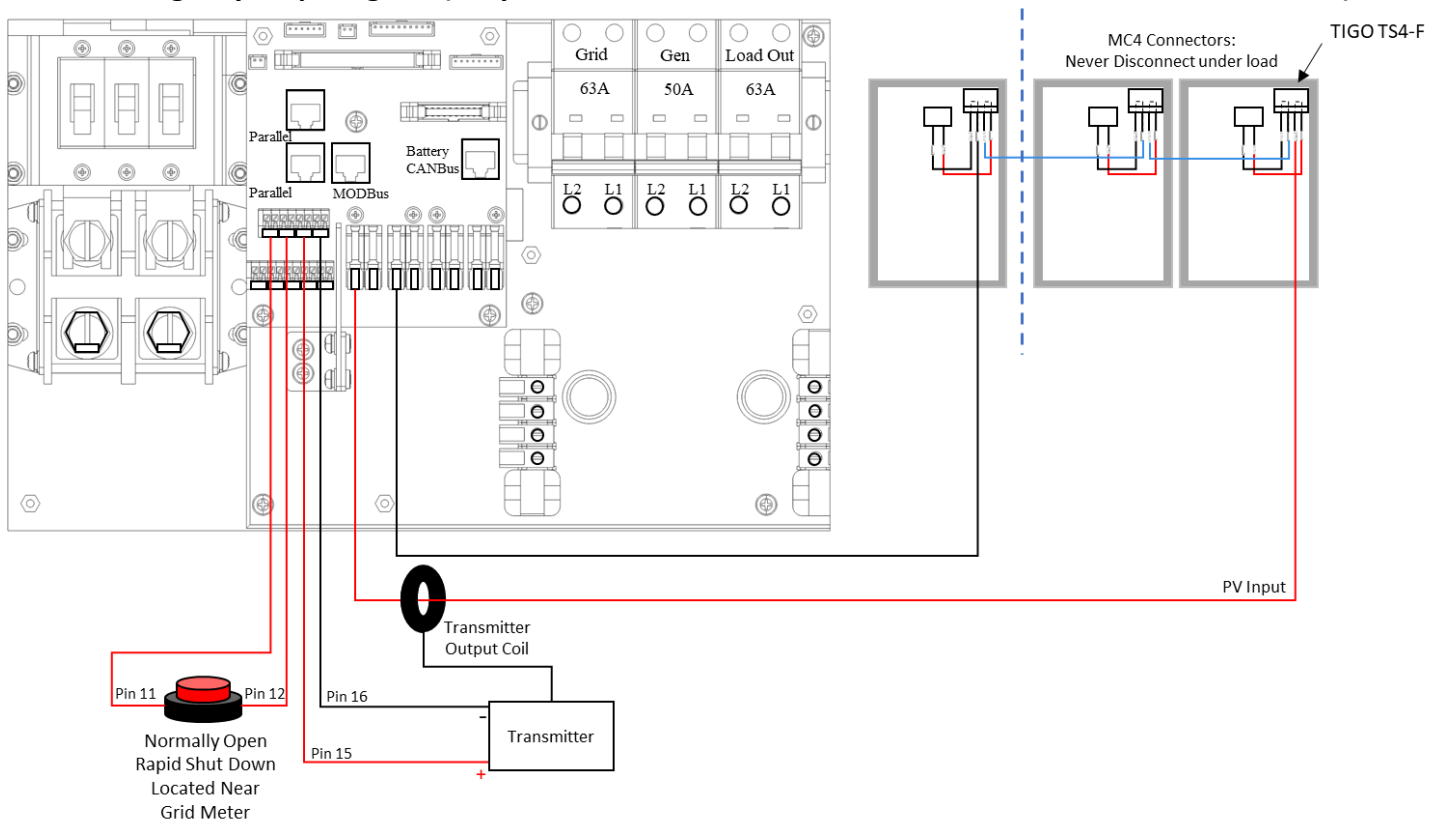

## Rapid Shutdown Hardware Diagram (Midnight RSD per PV string)

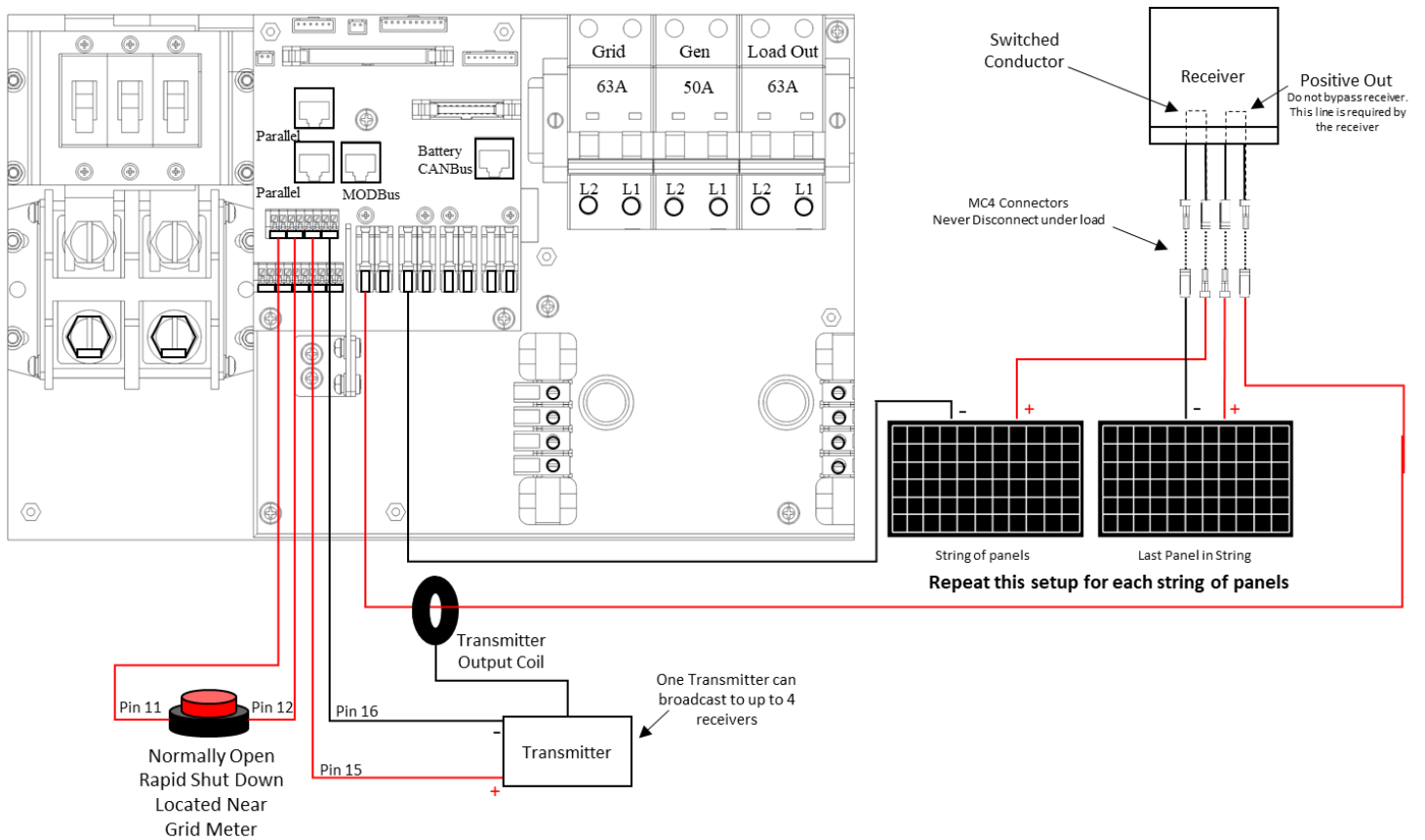

**Note: The Built in 12V power supply in the user area of the Sol-Ark (Pins 15 and 16) is rated for 100mA (1.2W)**

**Note: Transmitter fits inside the user area of the Sol-Ark 12K but can cause interference (placing it outside of the user area is sometimes needed)**

**Note: TIGO Optimizers are compatible with the Sol-Ark 12K (Do not use the built in 12V Power supply in the Sol-Ark user area to power the Tigo Optimizer TX transmitter)**



Sol-Ark-8K-48-ST Specifications	
Solar Output Power 9000W	
Max allowed PV Power	5500W+5500W = 11,000W
Max PV power delivered to Battery & AC outputs	12000W
Max DC voltage	500V@18A
MPPT voltage range	150-425V
Starting voltage	175V
Number of MPPT	2
Solar Strings per MPPT	2 w/o fuses, 3 w/ fuses
Max DC current per MPPT (self limiting)	18A@400V
Max AC Coupled Input (Micro/String Inverters)	9,600W / 9,600W
AC Output Power 8000W On Grid & 8000W Off Grid	
Connections	120/240/208V split phase
Continuous AC power to Grid (On-Grid)	8000W 33.3A L-L (240V) 4800W 40A L-N (120V)
Continuous AC power to Load (Off-Grid)	8000W 37.5A L-L (240V) 4800W 40A L-N (120V)
Surge AC power 10sec	16,000VA L-L (240V)
Surge AC power 16ms	25,000VA L-N (120V)
Parallel Stacking	Not Supported
Frequency	60/50Hz
Continuous AC power with Grid or Generator	15120W 63A L-L (240V) 7560W 63A L-N (120V)
CEC Efficiency	96.5% (Peak 97.5%)
Idle Consumption typical – no load	60W
Sell back power modes	Limited to Household or Full Grid-Tied
Design (DC to AC)	Transformerless DC
Response Time (Grid-Tied to Off-Grid)	4ms
Power Factor	+/-0.9 - 1.0
Battery (optional) Output Power 8000W	
Type	Lead-Acid or Li-Ion
Nominal DC Input	48V
Capacity	50 – 9900Ah
Voltage Range	43.0 – 63.0V
Continuous Battery charging output	185A
Charging curve	3-stage w/ equalization
Grid to Battery Charging Efficiency	96.0%
External temperature sensor	included
Current shunt for accurate % SOC	integrated
External Generator Start based on voltage or % SOC	integrated
Communication to Lithium battery	CanBus & RS485
General	
Dimensions (H x W x D)	30.0" x 18.30" x 10.00"
Weight	78 lbs
Enclosure	NEMA type 1 (Outdoor Rating Pending)
Ambient Temperature (3 variable speed fans)	-25 to 55C, >45C derating
Display	Color touch screen
Wi-Fi Communication (monitoring or SW updates)	included
Snap on sensors for limited selling to Household	included
Standard Warranty (verified by HALT testing)	5 years

Protection & Certifications	
Electronics certified safety by SGS labs to NEC & UL specs – NEC 690.4B & NEC 705.4/6	Yes
Grid Sell Back – UL1741-2010/2018, IEEE1547a-2003/2014, FCC 15 class B, UL1741SA, CA Rule 21, HECO Rule 14H	Yes
PV DC disconnect switch – NEC 240.15	integrated
Ground Fault Detection – NEC 690.5	integrated
PV rapid shutdown control – NEC 690.12	integrated
PV Arc Fault detection – NEC 690.11/ UL1699B	integrated
PV input lightning protection	integrated
AC input/output 50A breakers	integrated
Battery breaker / disconnect	integrated
User wiring enclosure w/ ¾" & 1" knock-outs	integrated
Solar Flare/EMP Hardened to 2015 MIL-STD-461G (Independently tested June 2018)	optional

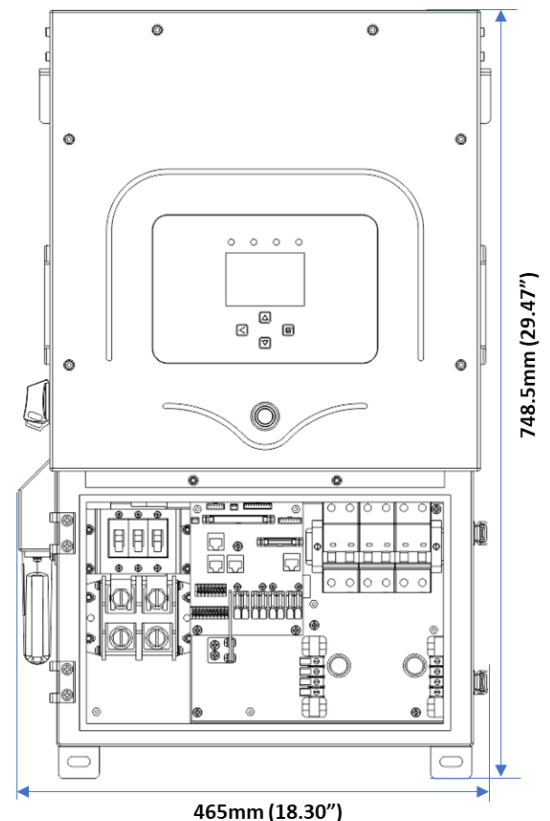
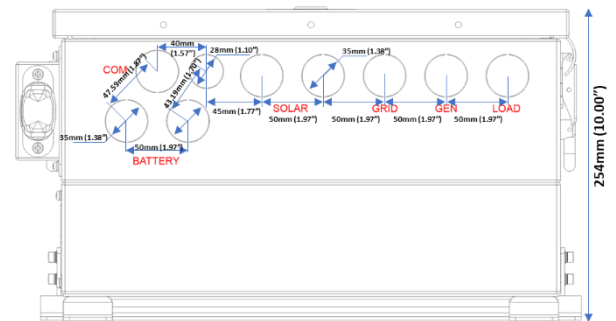



# Off-Grid Install Tips

- Limiter Sensors are not required for completely Off-Grid installs unless using gen peak shaving with a gen connected to grid input breaker.
- The Grid input breaker on the Sol-Ark should be used as the Generator input (4-30kW generators) so that you maintain Smart Load output capability when off-grid. Smart Load will allow you to run high power non-essential appliances (hot water, dehumidifier, heat pump, irrigation pump) on solar power instead of batteries. Therefore, you will use Grid Charge (default) in the Battery Setup/Charge menu.
- When off grid there is no need for a transfer switch, simply connect the load output of the Sol-Ark to the whole home.
- Do not use Grid Sell or Limited To Home Modes. Only Limited power to load (default).
- The Auto Generator start functions as a 2-wire switch (closes the circuit when needing charging)
  - Auto Gen-start will be triggered when the battery voltage or percent reaches the level programmed in the battery setup menu. Then once triggered the generator will continue to charge the batteries until they are about 95% full (this percentage is not programmable) before turning the generator off.
- When using a generator off-grid, we recommend changing the “grid reconnect time” under the Sell control tab of the grid setup menu to 30 seconds otherwise the Sol-Ark will not charge from the generator until it has been on for at least 5 minutes per the default value of 300 seconds.
- Under setup for Grid/Sell Control, select General Standard and “GEN connect to Grid Input”. Then go to Grid/Grid input to widen the input frequency range to 55-65Hz to work with any frequency generator.
- If you would like to use a wind turbine in conjunction with Sol-Ark 8k, the turbine must have a 48V charge controller with a dump load as to prevent overcharging of the batteries. Simply connect the charge controller on the turbine to the battery bank the Sol-Ark is using and the turbine will help charge your batteries.
- Don't forget to set the Battery capacity and proper charge rates.

## Grid-Tie / No Battery Install Tips

- Under Battery setup, select no Battery & disable Activate Battery (or system will beep).
- Note: full system power cycle maybe required when changing between battery and no battery settings.
- Under Grid Setup, select Grid Sell.
- Touch Battery Icon to see the Detailed Volts View to verify your inputs & outputs.

Solar	Grid	INV	Load	Batt
0W	0W 50.0Hz	0W 50.0Hz	0W	69W 87%
L1: 0V 0.0A 0W	117V HM: 0W LD: 0W	116V 0.2A 0W	116V 0W	51.13V 1.36A 0.0C
L2: 0V 0.0A 0W	117V HM: 0W LD: 0W	116V 0.2A 0W	116V 0W	DC:50.1C AC:40.3C

## Powering on the system:

1. Turn on the Built-In battery disconnect
2. Make sure that Sol-Ark 8k is properly connected to the batteries, panels, grid, etc. (see system wiring diagram).
3. Turn on grid power breakers.
4. Press the power button on the front of the unit.
5. Make sure Solar panel inputs are not connected to Ground, then Turn on DC disconnect switch.
6. Turn on load breakers.

## Indicator LEDs

- **DC**
  - Green = DC Solar Panels are producing
  - Off = Solar Panels are not producing
- **AC**
  - Green = Grid (or Gen or AC Coupled) is Connected
  - Off = Grid is not Connected
- **Normal**
  - Green = Sol-Ark 8k is working properly
  - Off = Sol-Ark 8k is not working properly
- **Alarm**
  - Red = Alarm, check the alarms menu
  - Off = No alarms

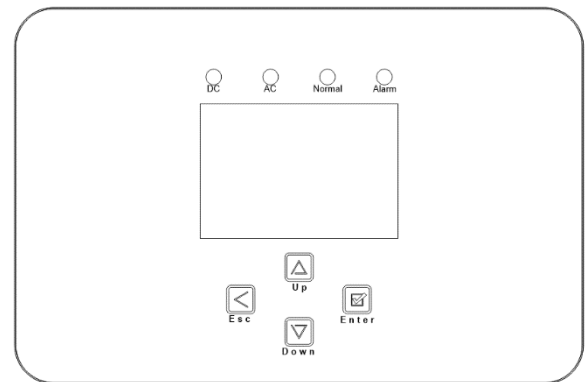

## Selecting your Power Mode:

Sol-Ark 8k will simultaneously use various power sources available to meet loads demand. The following power modes allow the user to determine the power sources available to Sol-Ark 8k.

- **Limited Load / Self Consumption**
  - Sol-Ark will only power loads connected to it. It will not produce more power than the connected loads require. This mode will neither sell back to the home nor grid.
- **Limited To Home (zeroing home meter)**
  - Pushes power to your whole home without selling back any excess to the grid (no net metering agreement required)
  - This mode requires the use of the limiter sensors
    1. Main Menu → System Settings → Grid Setup → Limiter → Limited to Home
  - Power source priority is same as Grid Sell Back
- **Grid Sell Back**
  - This Mode allows Sol-Ark 8k to sell back any excess power produced by the solar panels to the grid.
    1. Main Menu → System Settings → Grid Setup → Limiter → Grid Sell
  - Power source priority is as follows:
    1. Solar Panels
    2. Grid
    3. Generator
    4. Batteries (until programable % discharge is reached)
- **Time Of Use (using batteries during peak power times)**
  - Only available when using Limited To Home mode (Limiter sensors required) and/or Grid Sell Back (Limiter sensors not required) modes

Limiter	Sell Control	Grid Input	Time	Power	PowFac	Batt	Charge	Sell
<input checked="" type="checkbox"/>	Grid Sell	09000	01:00AM	2000	49.0V			
<input type="checkbox"/>	Limited Power to Home		05:00AM	2000	49.0V			
<input checked="" type="checkbox"/>	Limited Power to Load		09:00AM	2000	49.0V			
<input checked="" type="checkbox"/>	Time of Use	Setup	01:00PM	2000	49.0V			
			05:00PM	2000	49.0V			
			09:00PM	2000	49.0V			

- Use your batteries to reduce power consumption from the grid during a user programmable peak pricing window of time.
  1. Main Menu → System Settings → Grid Setup → Limiter → Time Of Use
- Power source priority:
  1. Solar Panels
  2. Batteries (until programmable % discharge is reached)
  3. Grid (can control when Grid charges)
- Off-Grid (powering loads)
  - This mode does not need to be programmed, Sol-Ark 8k will automatically operate in Off-Grid Mode in the absence of the grid.
  - Power source priority is as follows:
    1. Solar Panels
    2. Batteries
    3. Generator
- Note: Grid Sell and Limited to Home modes can be selected simultaneously
  - This changes the meaning of the load (light bulb) icon on the home screen to include both the load breaker power and the contribution of power being produced that is being consumed locally by the home.

#### **Backup Generator Setup:**

- Portable Generators (typically less than 10kW)
  - Connect to the generator output to the generator input breakers in the Sol-Ark 8k user panel.
  - Main Menu → System Settings → Battery Setup → Charge → Gen charge (only for Gen breakers)
- Standby Generators
  - Usually, large generators have a whole home transfer switch that feeds the home. If using a single 8k for your install, we suggest not using the generator input breakers in the Sol-Ark but your normal home wiring to distribute the Generator's power (through your existing Gen transfer switch). If using a multi-system install, then it may be advantageous to pass all generator power through the systems as shown on diagram 8.
  - If off grid, connect the output of the Generator directly to the Grid input on the Sol-Ark 8k. It can then treat the generator as if it were the grid.
  - Under setup for Grid/Sell Control, select General Standard and "GEN connect to Grid Input". Then go to Grid/Grid input to widen the input frequency range to 55-65Hz to work with any frequency generator.
  - Main Menu → System Settings → Battery Setup → Charge → Grid charge (only for Grid breakers)
- Auto Gen Start Signal
  - Automatically start compatible backup generators
  - The threshold at which gen charging is triggered can be set using the input boxes above the checkbox.
  - Main Menu → System Settings → Battery Setup → Charge → Gen or Grid charge (%Batt or V)

#### **Sensors:**

- Limiter Sensors (Current Sensors)
  - Placed on the grid side of your home breaker panel and are required to enable limited To Home mode (see diagrams). CT winding default ratio: 2000 : 1 but this ratio is programmable.
- Battery Temperature Sensor
  - Placed on the battery bank and used to adjust charging voltage and capacity calculations
- PV Shutdown signal
  - Used to accommodate Rapid Shutdown of PV components and discharge onboard capacitors
- CanBus / RS485
  - i. Used to communicate with Lithium batteries
  - ii. RS485 is SunSpec draft 4 (will not work with draft 3)

## Batteries:

Supported Battery Chemistries (48V configuration required for all chemistries)

- Lead Acid
  - AGM, Gel, Wet
- Lithium
  - NMC, LiPo4
- NiFe (Note: must use a 37 series cell configuration, 44.4V Nominal)
  - Set Absorb and Equalization to 61.0V, 3 hours, and days = 1 (every day). Float = 53.7V

## Programming Battery Settings

- g. Battery Capacity
  - i. This allows Sol-Ark to know the size of the battery bank
  - ii. Main Menu → System Settings → Battery Setup → Batt → Batt Capacity
- h. Battery Type
  - i. Navigate to the charge menu and set the values appropriate to your battery chemistry. The chart on page (36) is good reference for lead acid batteries.
  - ii. Main Menu → System Settings → Battery Setup → Charge
- i. Battery Discharge percentage
  - i. Allows the user to define the depth of discharge the system will allow before using the grid/generator to charge the battery bank. Solar is always the priority in charging the battery bank.
  - ii. Main Menu → System Settings → Battery Setup → Discharge

## Limiter Sensor Automatic Setup (Requires Batteries, AC coupled panels must be off while detecting, and does NOT work for 208V installs)

- 1) Install limiter sensors as described on page 27 (shown in all diagrams as well). Battery and grid connections also required before starting auto-setup.
- 2) Navigate to the “Advanced” Tab of the Basic Setup screen (follow the directions below to get there).
  - a) Touch the gear icon → Touch the Basic Setup button → Select the Advanced tab (see Fig. G).
- 3) Select “Auto detect Home Limit Sensors” and press ok.
- 4) Wait for the Sol-Ark to finish its learning process (Sol-Ark will alternate sell back between legs and magnitude automatically determining the correct settings for the sensors).
- 5) Verify sensors were correctly configured (see Fig. H) if they are not correct, repeat the learn function.

Fig. G

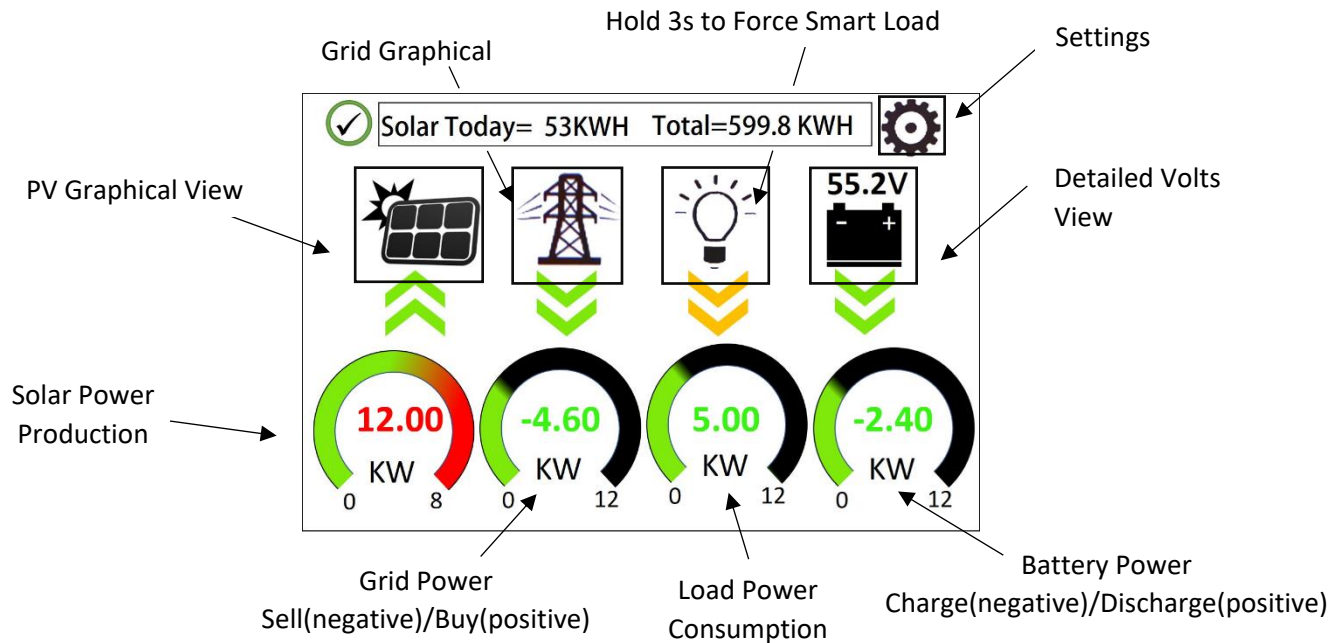

Fig. H



## Screens

### • Home Screen (Touchscreen)



### • Detailed Volts View

- Top row = Total power for column
- Middle Row = Line 1/PV1 voltage, Amps, and Watts (note: PV Voltage not to exceed 500)
- Bottom Row = Line 2/PV2 voltage, Amps, and Watts (note: PV Voltage not to exceed 500)
- Batt Temperature will show -20°C if temperature sensor is not connected.
- Batt SOC % = % batteries are charged
- DC Temp = Temperature of DC conversion electronics
  - Batt → AC
  - PV → Batt
  - AC → Batt
- AC Temp = Temperature of AC conversion electronics
  - Batt → AC
  - PV → AC
- Grid Column
  - If selling to grid, Grid Watts = negative
  - If buying from grid, Grid Watts = positive
  - Note: If these values are reversed, current sensors may have been installed incorrectly (reverse polarity).
  - HM = Power detected by the external current sensors on entire home L1 & L2
  - LD = Power detected using internal sensors on AC grid in/out breaker

Solar	Grid	INV	Load	Batt
0W	0W	0W	0W	69W
	50.0Hz	50.0Hz		87%
L1: 0V	117V	116V	116V	51.13V
0.0A	HM: 0W	0.2A		1.36A
0W	LD: 0W	0W	0W	0.0C
L2: 0V	117V	116V	116V	
0.0A	HM: 0W	0.2A		DC:50.1C
0W	LD: 0W	0W	0W	AC:40.3C

- **PV Graphical View**
  - Displays power production over time for the PV array
  - Use up/down buttons to navigate between days
  - Month view, Year view, and Total view
- **Grid Graphical View**
  - Displays power drawn from and sold to the grid over time
  - Bars above the line indicate power bought from the grid
  - Bars below the line indicate power sold back to the grid
  - This view can be helpful in determining when the most power is used in the home and for time of use programing
- **System Setup Menu**
  - ID = LCD serial #. But we use the WIFI serial #.
  - COMM = LCD software version
  - MCU = Inverter software version
- **System Alarms**
  - Lists all system alarms
- **Basic Setup**
  - Display
    - Brightness adjustment
    - Auto dim (must be enabled for LCD screen to be covered by warranty)
  - Time
    - Set date and time for the system
  - Alarms & Safety
    - Arc fault detects if a poor connection in the PV wires
  - Grid Peak Shaving
    - Set the threshold that the Sol-Ark will begin contributing Power to keep the power drawn from the grid below the threshold.
  - Gen Peak Shaving
    - Set the threshold at which the Sol-Ark will contribute to the generator to prevent large loads overloading the generator.
  - Parallel
    - Not Used for 8Ks
- **Batt Setup**
  - Batt
    - Batt Capacity: enter the size of the battery bank connected to the system
    - Max A charge: set the max charge rate for the batteries (This also sets PV → Battery charge rate)
    - Suggest 20%-30% of battery capacity for lead acid
    - Max A discharge: set max discharge for battery bank (In off-grid mode, the battery bank will discharge 120% of this value for 10 seconds before the inverter shuts down to prevent battery damage)

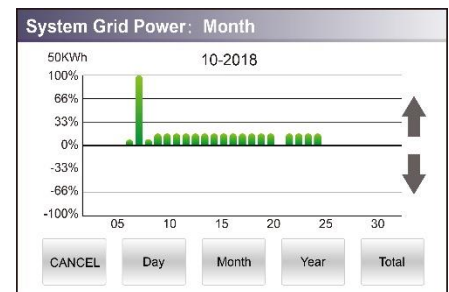

**System Setup** 10/24/2018 02:23:10

Basic Setup

Battery Setup

Grid Setup

System Alarms

Li-Batt Info

-ID: 1807264001 SD  
-COMM: 1295  
-MCU: Ver0748

**System Alarms** 10/24/2018 01:54:21

Alarms Code	Occurred
F56 DC_VoltLow_Fault	2018-10-24 01:07
F56 DC_VoltLow_Fault	2018-10-24 01:07
F56 DC_VoltLow_Fault	2018-10-24 01:00
F56 DC_VoltLow_Fault	2018-10-24 00:55
F56 DC_VoltLow_Fault	2018-10-24 00:43
F56 DC_VoltLow_Fault	2018-10-24 00:10
F56 DC_VoltLow_Fault	2018-10-24 00:08
F56 DC_VoltLow_Fault	2018-10-24 00:07

**System Setup**

Display Time Advanced Alarms&Safety Factory Reset Parallel

☐ Solar Arc Fault ON
☐ Clear Arc\_Fault

☐ Gen peak-shaving Power 7000W

☒ Grid peak-shaving Power 4000W

☐ Auto detect Home Limit Sensors

CANCEL OK

**System Setup**

Display Time Alarms&Safety Factory Reset

Brightness

Beep ☐

Auto Dim 600S

CANCEL OK



- TEMPCO: Temperature coefficient used in conjunction with the batt temp sensor to adjust optimal voltages for lead acid batteries
- Use Batt V charged: displays battery charge in terms of voltage
- Use Batt % charged: Battery voltage can be misleading for determining the % Charged. So, we use algorithms measuring power in and out to measure a true value for % Charged. It compensates for aging batteries also.

Batt	Charge	Discharge	Smart Load
Batt Capacity	400Ah		<input type="checkbox"/> Use Batt V charged
Max A Charge	40A		<input checked="" type="checkbox"/> Use Batt % Charged
Max A discharge	60A		<input type="checkbox"/> No Battery
TEMPCO	-5mV/C/Cell		<input type="checkbox"/> BMS Lithium Batt 01
			<input checked="" type="checkbox"/> Activate Battery

#### ○ Charge

- Float V: Set value appropriate for the batteries connected to the system using chart (Page 36)
- Absorption: Set value appropriate for the batteries connected to the system using chart (Page 36)
  - Absorption will stop at 1% of the capacity of the battery bank and drop to float
  - Ex: 400Ah battery would be 4A
- Equalization: Set value appropriate for the batteries connected to the system using chart (Page 36)
- Days: period between equalization cycles
- Hours: period taken to equalize batteries
  - Note if Hours = 0 system will not equalize the batteries
- Gen Charge: uses the gen input of the system to charge battery bank from an attached generator.
  - Start V: voltage at which system will AutoStart a connected generator to charge the battery bank
  - Start percentage: Percent S.O.C at which system will AutoStart a connected generator to charge the battery bank
  - A: charge rate from the attached generator in Amps
    - Note: size this value appropriately for your given generator size
- Grid Charge
  - Start V: voltage at which system will charge the battery bank from the grid. If grid is on, batteries will stay at float voltage.
  - Start percentage: Percent S.O.C at which system will AutoStart a connected generator to charge the battery bank
  - A: charge rate from the grid in Amps

Batt	Charge	Discharge	Smart Load
Start V	49.0V	49.0V	Float V 55.2V
Start %	30%	30%	Absorption V 57.6V
A	40A	60A	Equalization V 58.8V
			90 days
			2.0 hours
<input type="checkbox"/> Gen Charge <input checked="" type="checkbox"/> Grid Charge			

#### ○ Discharge

- Shutdown V: battery voltage at which the inverter will shut down (batt symbol on home screen will turn red)
- Low Batt: Low battery voltage (batt symbol on home screen will turn yellow)
- Restart: battery voltage at which AC output will resume
- Batt Resistance: used in % SOC batt calculations
- Batt Charge Efficiency: used in % SOC batt calculations
- Batt Empty V: sets reserve capacity and improve % SOC calculations. It is not Batt\_I adjusted.
  - (Recommendations: 45V for AGMs, 48V for Lithium Iron Phosphate)

Batt	Charge	Discharge	Smart Load
Shutdown	46.0V	20%	Batt Resistance 25mOhms
Low Batt	47.5V	35%	Batt Charge Efficiency 99.0%
Restart	52.0V	50%	
Batt Empty V	47.0V		

- **Smart Load (Gen Load)**

- This mode utilizes the Gen input connection as an output which only receives power when the battery is above a user programmable threshold.
- The Gen input breaker in the user area of the system becomes an output to high power loads such as a water heater, irrigation pump, ac unit, pool pump.
- Smart Load OFF Batt
  - Battery voltage at which the Gen load will stop being powered
- Smart Load ON Batt
  - Battery voltage at which the gen load will start being powered
- Note: If using Gen load for a water heater, it is recommended that only one leg (120V) be connected to the bottom element. This significantly reduces the power consumption of the water heater while retaining core functionality (it will heat water, only slower).
- Note: Gen Load is limited to 40A at 240V (Do not exceed!)

- Solar Watts is for on grid.
  - System waits to turn on smart load until enough PV power is produced (when on grid).
- **AC Coupling Settings (For Micro Inverter Input)**
  - To use the Gen input breaker as a micro inverter AC coupled input, check the “For Micro inverter Input” box (this feature will also work with “Grid-Tied” Inverters)

- Maximum combined input to Sol-Ark (AC+DC)
  - Best: 3kWAC + 11kWDC (8KW sell)
  - Good: 2kWAC + 11kWDC (8KW sell)
  - OK: 4kWAC + 7kWDC
  - Poor: 5kWAC + 6kWDC
  - Poor: 6kWAC + 5kWDC

- To use the LOAD breaker for AC coupling grid tied inverter(s)
  - You must select “For Micro Inverter Input”
  - The Gen Breaker is not used (even though the GEN breaker is not physically being used for this mode, AC coupling on the LOAD breaker prevents the use of the GEN breaker)
  - Wire as show in the preceding example diagram labeled “Load side AC coupling example”
  - Note: some load side AC coupling installs will require a line side tap instead of the 50A breaker shown in the example diagram
  - Maximum combined input to Sol-Ark (AC+DC)
- Note: when AC coupling “For Micro Inverter Input must be selected”
  - The meaning of Smart Load OFF Batt and Smart Load ON Batt change in this mode
    - Smart Load OFF Batt: The SOC at which the AC coupled inverter(s) are shut down when in off-grid mode
      - 90% recommended
    - Smart Load ON Batt: The SOC at which the AC coupled inverter(s) are turned on when in off-grid mode
      - 60%-80% recommended
    - When on grid the AC coupled inverter will always be on and the power it produces will be sold back to the grid. **Limited To Home mode will not function with AC coupled PV arrays.**



- **Grid Setup**

- **Limiter**

- **Grid Sell:** maximum watts sold to grid
    - **Limited To Home:** Limits power produced by the system to match the demand of the home
    - **Limited To Load:** Limits power produced by the system to match the demand of connected loads
    - **Time Of Use:**
      - **Time:** When the system will sell batt/PV power to the grid or home
      - **Power(W):** Max watts to be sold from the battery only at each time
      - **Batt:** The battery voltage or % at which the system will limit selling to the grid or home from the battery. The system will drain the battery until that percent/voltage is reached.
      - **Grid Charge:** Enables grid charging during a selected period up to the voltage or percentage specified on the line. PV will always charge to 100%.
      - **Gen Charge:** Enables a generator to be called during this time period, if not checked generator will not be called for even if the start voltage/% is reached. If the generator is running and then the next time slot is reached and does not have gen charge checked, the generator will be turned off. Otherwise the generator will only be turned off once the charging amperage accepted by the battery bank reaches 5% of its rated capacity in amps. For example, if you had a 100Ah battery the generator would be turned off once the battery only accepted 5 amps of charging current.
      - **For Examples:** See Pages 39-40
  - **Note:** This mode requires Grid sell / limited to home be enabled.
  - **Note:** If you need the batteries to never charge from the grid, uncheck the “Grid Charge” box under the charge tab of the battery menu (see page 31).

Time	Power(W)	Batt	Charge	Set
01:00AM	2000	49.0V		
05:00AM	2000	49.0V		
09:00AM	2000	49.0V		
01:00PM	9000	49.0V		
05:00PM	2000	49.0V		
09:00PM	2000	49.0V		

- **Sell Control**

- **General Standard:** uses Protect Parameters in table
    - **UL 1741 & IEEE1547:** Enables sell compliant functionality
    - **UL1741SA:** Enables wider Freq, Voltage, and Power Factor
    - **GEN connect to Grid Input:** Must be set if Generator is connected to AC Grid breaker

Grid Reconnect Time: 60s  
Power Factor: 1.000  
GEN connect to Grid input: ☐

- **Grid Input**

- **Grid Frequency:** Select the frequency of the grid connected to the system
    - **Grid Type:**
      - 220V Single Phase (Call us before using)
      - 120/240 Split Phase (North America)
      - 120/208V 3 Phase
      - **Note:** If 120/208V, the L1 and L2 are phase specific. So, you may have to swap Grid L1 L2 for 208V applications.
      - **Note:** Inverter power cycle is required each time the input/output voltage is changed
  - **Protect Parameters (when**
    - Settings when the system will connect/disconnect from grid
    - This is not used when UL 1741 & IEEE1547 is enabled
    - You may need to widen the frequency range when using a generator (55-65 Hz)

Grid Frequency: ☒ 50Hz ☐ 60Hz  
Grid Type: ☒ 220V Single Phase ☐ 120/240V Split Phase ☐ 120/208V 3 Phase  
Protect Param: Grid Vol High: 264.0V, Grid Vol Low: 211.0V, Grid Hz High: 60.5Hz, Grid Hz Low: 45.0Hz

- FreqVolt (UL 1741SA must be enabled in “Sell Control” tab)

- **Puerto Rico Grid Compliance Settings:**

**Grid Param**

Limiters Sell Control Grid Input FreqVolt PowFac

☒ L/HVRT ☒ L/HFRT

HV2: 288V	0.16S	HF2: 61.5Hz	10S
HV1: 264V	1S	HF1: 60.5Hz	300S
LV1: 211.2V	2S	LF1: 59.2Hz	300S
LV2: 144V	1S	LF2: 57.5Hz	10S
LV3: 108V	0.16S		

CANCEL OK

- **Kauai Grid Compliance Settings:**

**Grid Param**

Limiters Sell Control Grid Input FreqVolt PowFac

☒ L/HVRT ☒ L/HFRT

HV2: 288.0V	0.16S	HF2: 64.00Hz	0.16S
HV1: 264.0V	5S	HF1: 63.00Hz	20S
LV1: 204.0V	20S	LF1: 57.00Hz	20S
LV2: 120.0V	0.16S	LF2: 56.00Hz	0.16S
LV3: 110.0V	0.16S		

CANCEL OK

**Grid Param**

Limiters Sell Control Grid Input Freq Volt PowFac Relay

☒ QV ☒ FW ☐ VW

V1: 225.6 V	Q1: 0.44	Fstart: 60.10 Hz	Vstart: 254.4 V
V2: 232.8V	Q2: 0.00	Fstop: 62.40 Hz	Vstop: 264.0 V
V3: 247.2 V	Q3: 0.00	RT: 0.5 s	RT: 10 s
V1: 254.4 V	Q4: 0.44		
Response Time: 10 s		Normal Ramp Rate: 100.0 %	Soft Start Ramp Rate: 0.3 %

Cancel OK

- **HECO Grid Compliance Settings for O’ahu, Maui, Hawai’i:**

**Grid Param**

Limiters Sell Control Grid Input FreqVolt PowFac

☒ L/HVRT ☒ L/HFRT

HV2: 288.0V	0.16S	HF2: 64.00Hz	0.16S
HV1: 264.0V	1S	HF1: 63.00Hz	20S
LV1: 211.2V	20S	LF1: 57.00Hz	20S
LV2: 168.0V	10S	LF2: 56.00Hz	0.16S
LV3: 120.0V	0.16S		

CANCEL OK

**Grid Param**

Limiters Sell Control Grid Input Freq Volt PowFac Relay

☒ QV ☒ FW ☐ VW

V1: 225.6 V	Q1: 0.44	Fstart: 60.10 Hz	Vstart: 254.4 V
V2: 232.8V	Q2: 0.00	Fstop: 62.40 Hz	Vstop: 264.0 V
V3: 247.2 V	Q3: 0.00	RT: 0.5 s	RT: 10 s
V1: 254.4 V	Q4: 0.44		
Response Time: 10 s		Normal Ramp Rate: 100.0 %	Soft Start Ramp Rate: 0.3 %

Cancel OK

- **HECO Grid Compliance Settings for Lana’I and Moloka’i:**

**Grid Param**

Limiters Sell Control Grid Input FreqVolt PowFac

☒ L/HVRT ☒ L/HFRT

HV2: 288.0V	0.16S	HF2: 65.00Hz	0.16S
HV1: 264.0V	1S	HF1: 63.00Hz	20S
LV1: 211.2V	20S	LF1: 57.00Hz	20S
LV2: 168.0V	10S	LF2: 50.00Hz	0.16S
LV3: 120.0V	0.16S		

CANCEL OK

**Grid Param**

Limiters Sell Control Grid Input Freq Volt PowFac Relay

☒ QV ☒ FW ☐ VW

V1: 225.6 V	Q1: 0.44	Fstart: 60.10 Hz	Vstart: 254.4 V
V2: 232.8V	Q2: 0.00	Fstop: 62.40 Hz	Vstop: 264.0 V
V3: 247.2 V	Q3: 0.00	RT: 0.5 s	RT: 10 s
V1: 254.4 V	Q4: 0.44		
Response Time: 10 s		Normal Ramp Rate: 100.0 %	Soft Start Ramp Rate: 0.3 %

Cancel OK

- **PowFac**

- Power Factor is programmable from 0.8 – 1.0.

# Sol-Ark 8k Menus

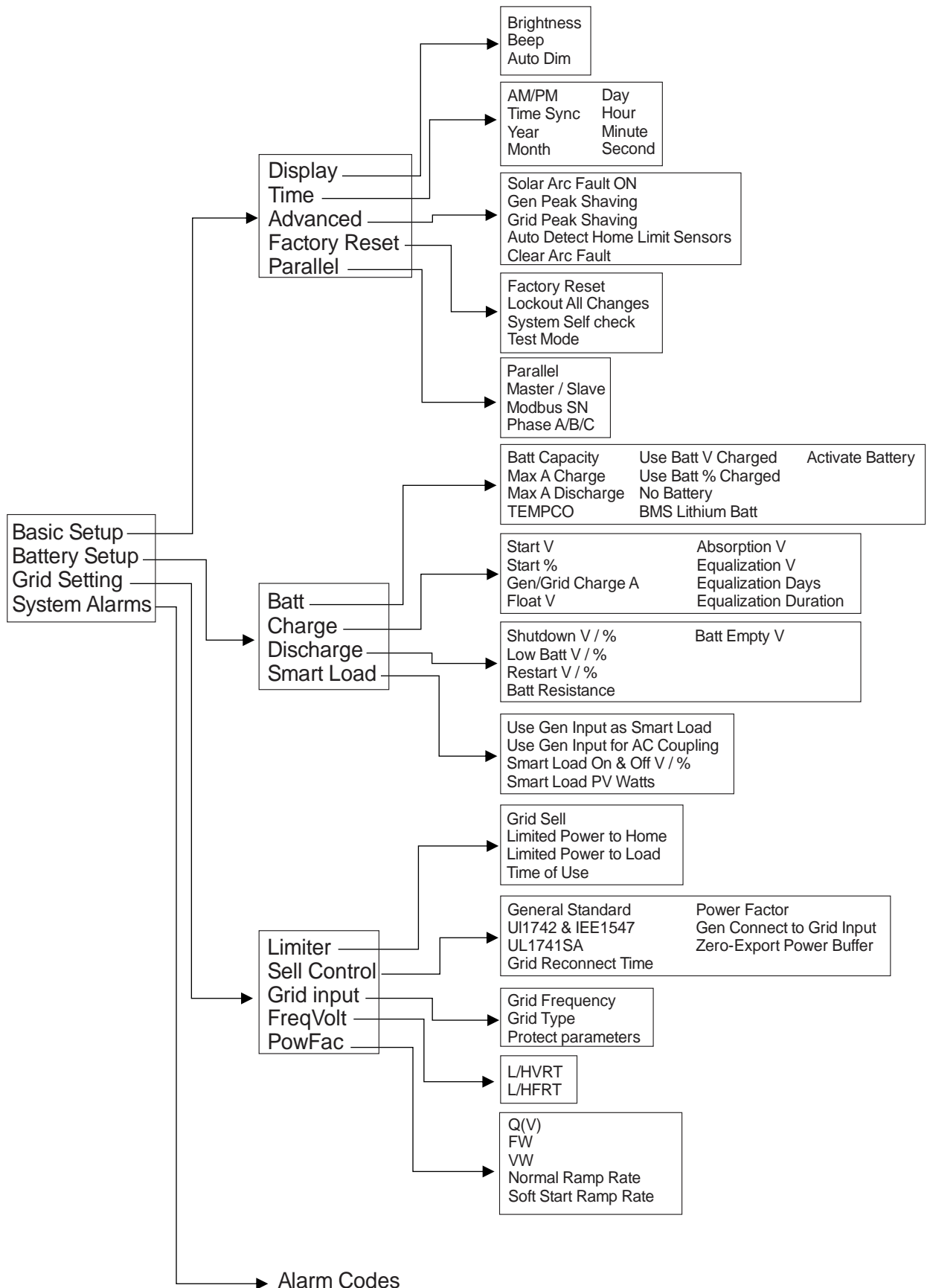

## Battery Charging Information

### 4-Stage Charging

The MPPT has a 4-stage battery charging algorithm for rapid, efficient, and safe battery charging. The figure below shows the stage sequence.

MPPT Charging Algorithm

#### Bulk Charge Stage

In Bulk Charge stage, the battery is not at 100% state of charge and battery voltage has not yet charged to the Absorption voltage setpoint. The controller will deliver 100% of available solar power to recharge the battery.

#### Absorption Stage

When the battery has recharged the absorption voltage setpoint, constant-voltage regulation is used to maintain battery voltage at the absorption setpoint. This prevents heating and excessive battery gassing. The battery is allowed to come to full state of charge at the absorption voltage setpoint. Absorption lasts until batteries charge at 1% of programmed Ah size.

#### Float Stage

After the battery is fully charged in the Absorption stage, the MPPT reduces the battery voltage to the float voltage setpoint. When the battery is fully recharged, there can be no more chemical reactions and all the charging current is turned into heat and gassing. The float stage provides a very low rate of maintenance charging while reducing the heating and gassing of a fully charged battery. The purpose of float is to protect the battery from long-term overcharge.

#### Battery Charging Setpoint (48V)

Battery Type	Absorption Stage	Float Stage	Equalize Stage (every 30 days 3hr)
AGM (or PCC)	14.4v ( <b>57.6v</b> )	13.5v ( <b>53.6v</b> )	14.4v ( <b>57.6v</b> )
Gel	14.1v ( <b>56.4v</b> )	13.5v ( <b>54.0v</b> )	
Wet	14.7v ( <b>59.0v</b> )	13.7v ( <b>55.0v</b> )	14.7v ( <b>59.0v</b> )
Lithium	14.1v ( <b>54.6v</b> )	13.2v ( <b>54.3v</b> )	14.1v ( <b>54.6v</b> )

Default

#### Note:

When batteries are in series, the voltages add to each other.

When batteries are in parallel the Amp hours add to each other.

How to calculate Amp Hours for your battery bank (PCC 230):

Battery Count	Voltage per Battery	Amp Hours per Battery	Total Amp Hours @48V	Max Charge/Discharge Amp
4	12V	230Ah	230Ah	100A
8	12V	230Ah	460Ah	185A
12	12V	230Ah	690Ah	185A
16	12V	230Ah	920Ah	185A

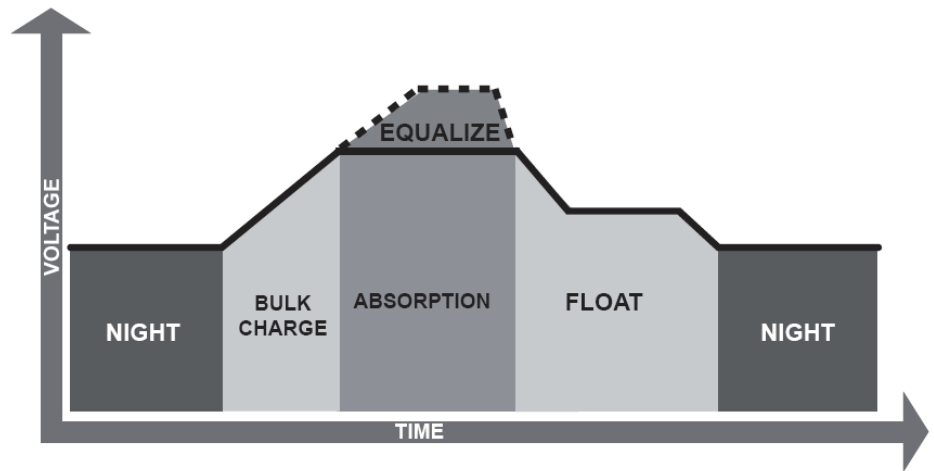

## Troubleshooting Guide

- **LCD is not powering on**
  - Check all connections
    - At least one of the following power sources is required: PV/Grid/Battery
  - Try pressing the power button. Or touchscreen or navigation button.
- **Panels are connected but DC Light is not on**
  - PV voltage must be 150V-500V
  - It's night
- **Panels are not producing**
  - Check all solar panel connections are wired properly
  - Turn on PV disconnect
  - Check that the PV input voltage is not greater than 500V
  - If system says PV=0V, check PV polarity
- **Panels are not producing much power**
  - PV Wire Strip Length: 5/8". Your batteries may be charged, you can test Grid Sell to verify.
- **System not keeping batteries charged**
  - Check the charge setting in the Charge Menu
- **Auto Gen-Start not working**
  - Check to make sure your generator is compatible with Auto Start
  - Make sure that the Auto Gen Start wire is connected properly to the Sol-Ark 8k and the generator
- **Normal LED isn't on**
  - Sol-Ark 8k is not working properly (Call us)
- **Alarm Light is on**
  - Check the system alarms menu to see which alarm has been triggered
- **Grid HM value is negative when it should be positive (only applies in limited home mode)**
  - Limiter Sensors are installed backwards or L1/L2 sensors are swapped or L1/L2 sensors mis-wired. Try Autolearn.
- **AC Overload Fault or Bus Unbalance Fault**
  - Check Transfer Switch/Subpanel wiring
  - Check for large loads that pull more than the inverter is rated for (EX: AC units over 3 tons)
- **System connects to grid and quickly disconnects**
  - With a DMM, verify your Neutral wire is connected (should be 0Vac referenced to GND)
  - Check your Freq is set to 60Hz and the 8k see's 120V on L1 & L2 to N.
  - If overloading: verify 120/240V grid input and load output wires are not swapped.
  - If 120/208V, the L1 and L2 are phase specific. So, you may have to swap Grid L1 L2 for 208V applications.
- **DC Overload Fault**
  - Check PV voltage
  - Make sure you have not wired more than 2 solar stings in parallel
- **System is beeping**
  - Check the system alarms menu to see which alarm has been triggered. Most alarms will self-reset.
  - There is no battery connected. If not using a battery, select no battery and disable activate batt in Batt menu.
    - To fully reset system, turn off center button, remove AC Grid and PV Power for 30s (screen is dead), then power up.
- **Battery cable is sparking when connected**
  - Put the built-in battery breaker in the off position before connecting or disconnecting batteries.
- **Battery symbol on home screen is red**
  - Battery is under voltage or over voltage
- **Battery symbol on home screen is yellow**
  - Battery is low or charge/discharge current is close to the programmed limit (which is ok)
- **Grid symbol on home screen is yellow**
  - Grid parameters are out of specified range or grid is down
- **System has restarted**
  - Happens if: System is overloaded, Battery voltage is greater than 63V, or Software update

- **Batteries were connected backwards**
  - Battery breaker will trip. Can cause damage!
- **Why is LCD screen still on when power button is off?**
  - If PV or Grid power, LCD stays on but inverter and loads are off.
- **The Batt % meter is not reaching 100%**
  - System needs to go through a small discharge/charge cycle to first calibrate battery
- **Generator setup is reading 0Hz**
  - Select “General Standard” instead of UL1741. Then widen the voltage range to 53Hz-65Hz.
- **Color Touchscreen is Frozen**
  - Press and hold the escape button [←] for 7-10 seconds

### Sol-Ark 8k Error Codes

Fault	Instruction	Common Cause/Remedy
F1	DC Inversed Failure	Notification of power down, not a fault.
F8	GFDI_Relay_Failure	Current Leakage from inverter AC output to ground, check ground and neutral are connected at the main panel
F10	AuxPowerBoard_Failure	Contact Sol-Ark.com
F13	Grid_Mode_change	Can happen when not using batteries or if Grid Input settings are changed. This is a notification, NOT a fault. If you change from No Batt to Battery mode, power system down completely to restart.
F15	AC_OverCurr_Failure	Usually caused by Loads being too large for the inverter. If off-grid, the battery discharge amps programmed too low. Overloads can result in F15, F18, F20, or F26.
F16	GFCI_Failure	Ground fault. Check PV+ or PV- wiring (which must be ungrounded). Exposed PV conductors + rain can also cause. Check that neutral line and Ground is not double bonded (which is common with portable generators).
F17	Active_Battery_Hold	Contact Sol-Ark.com
F18	Tz_Ac_OverCurr_Fault	Overloaded the Load Output, reduce loads. Wiring Short on the AC Side can also cause this error. Overloads can result in F15, F18, F20, or F26.
F20	Tz_Dc_OverCurr_Fault	Usually caused by DC current from battery that are too large (ex: 4 Ton AC Unit). Overloads can result in F15, F18, F20, or F26.
F23	Tz_GFCI_OC_Fault	PV Ground fault. Check PV+ or PV- wiring (which must be ungrounded or damage can occur). Typically caused by pinched PV wire grounding the PV+ or PV-. Grounded PV wire can cause F20, F23 or F26.
F24	DC_Insulation_Fault	Exposed PV conductor combined with moisture is faulting (can cause F16, F24, F26).
F25	AC_Active_Batt_Fault	Contact Sol-Ark.com
F26	BusUnbalance_Fault	Too much load one leg (L1 or L2) Vs the other leg or DC loads on the AC output when off-grid. Grounded PV wire can cause F20, F23 or F26.
F30	AC_MainContactor_Fault	Contact Sol-Ark.com
F31	Soft_Start_Failed	Soft Start of large motor failed
F34	AC Overload Fault	AC Overload or load shorted. Please reduce heavy loads.
F35	AC_NoUtility_Fault	Grid connection lost
F37	DCLLC_Soft_Over_Cur	Software DC overcurrent
F39	DCLLC_Over_Current	Hardware DC overcurrent
F40	Batt_Over_Current	Current discharge limit for batteries was exceeded
F45	AC_UV_OverVolt_Fault	Grid under voltage causes disconnect. This will self-reset when grid stabilizes.
F47	AC_OverFreq_Fault	Grid over Frequency (common in power outages) causes disconnect. Will self-reset when grid stabilizes.
F48	AC_UnderFreq_Fault	Grid under Frequency (common in power outages) causes disconnect. Will self-reset when grid stabilizes.
F49	AC_U_GridCurr_DcHigh_Fault	Contact Sol-Ark.com
F55	DC_VoltHigh_Fault	PV maybe higher than 500V. Battery voltage should not be above 59V or 63V (depending on model).

F56	DC_VoltLow_Fault	Batteries are overly discharged or Lithium BMS has shutdown. If battery settings are off, this can also
F60	Gen_Volt_or_Fre_Fault	Generator Voltage or Frequency went outside allowable range
F63	ARC_Fault	Can be a bad PV connector/connection. And sometimes a false alarm due to powerful lightning storms.
F64	Heatsink_HighTemp_Fault	Check the built-in fans are running, ambient temp may be to high

### **Common Battery Application Notes**

#### **Sol-Ark PCC-230 Battery**

Batt Capacity: 230Ah x #Parallel\_Batteries  
 (1 parallel = 4 Batt in series, 2 = 8 Batt, 3 = 12 Batt, 4 =16 Batt)  
 Max A Charge: 100A x #Parallel\_Batteries  
 Max A Discharge: 100A x #Parallel\_Batteries  
 Max A Grid Charge: 50A x #Parallel\_Batteries  
 TEMPCO: -5mV/C/Cell  
 Float V: 53.6V  
 Absorption V: 57.6V  
 Equalization V: 57.6V  
 Equalization Days: 30  
 Equalization Duration: 3 Hours  
 Recommended Shutdown V / Percentage: 47.0V & 20%  
 Recommended Low Batt V / Percentage: 47.5V & 35%  
 Recommended Restart V / Percentage: 52.0V & 50%  
 Battery Resistance: 35mOhms (8 Batt) or 25mOhms (16 Batt)  
 Battery Charge Efficiency: 99%  
 Battery Empty Voltage: 45V

Time	Watts	SOC	GridCharge
1:00AM	1500*Par_Batts	70%	
5:00AM	1500*Par_Batts	70%	
9:00AM	1500*Par_Batts	70%	
1:00PM	1500*Par_Batts	100%	
4:00PM	1500*Par_Batts	70%	
9:00PM	1500*Par_Batts	70%	

These settings will charge the batteries off solar only.  
 Discharge the batteries down to a maximum of 70% full.

Limited To Home mode will not sell to the grid from the  
 batteries (only the home will use battery power). The  
 100% time slot is to ensure that the batteries are  
 properly cycled each day.

#### **Generation 2 Fortress Battery-eVault18.5**

Batt Capacity: 360Ah x #Parallel\_Batteries  
 Max A Charge: 150A (100A for life) x #Parallel\_Batteries  
 Max A Discharge: 160A x #Parallel\_Batteries  
 Max A Grid Charge: 100A x #Parallel\_Batteries  
 TEMPCO: 0mV/C/Cell  
 BMS Lithium Batt: Not Selected  
 Float V: 54.4V  
 Absorption V: 54.6V  
 Equalization V: 54.6V  
 Equalization Days: 30  
 Equalization Duration: 1 Hours (tops off battery)  
 Recommended Shutdown V / Percentage: 51.3V & 20%  
 Recommended Low Batt V / Percentage: 51.7V & 30%  
 Recommended Restart V / Percentage: 51.9V & 40%  
 Battery Resistance: 5mOhms  
 Battery Charge Efficiency: 99%  
 Battery Empty Voltage: 47V

Time	Watts	SOC	GridCharge
1:00AM	6000*Par_Batts	40%	
5:00AM	6000*Par_Batts	40%	
9:00AM	6000*Par_Batts	40%	
1:00PM	6000*Par_Batts	40%	
5:00PM	6000*Par_Batts	40%	
9:00PM	6000*Par_Batts	40%	

These settings will charge the batteries off solar only.  
 Discharge the batteries down to a maximum of 40% full.

Limited To Home mode will not sell to the grid from the  
 batteries (only the home will use battery power).

**Simpliphi Power: PHI 3.8 Battery 48V**

Batt Capacity: 75Ah x # Batt  
 Max A Charge: 34A x # Batt (20A for better lifespan)  
 Max A Discharge: 60A x # Batt (34A for better lifespan)  
 Max A Grid Charge: 20A x # Batt  
 TEMPCO: 0mV/C/Cell  
 BMS Lithium Batt: Not Selected  
 Float V: 54.0V  
 Absorption V: 54.4V  
 Equalization V: 56V  
 Equalization Days: 30  
 Equalization Duration: 1 Hours (tops off battery)  
 Recommended Shutdown V / Percentage: 50.2V & 20%  
 Recommended Low Batt V / Percentage: 50.6V & 30%  
 Recommended Restart V / Percentage: 51.0V & 40%  
 Battery Resistance: 8mOhms (3 Batt) 4mOhms (6 Batt)  
 Battery Charge Efficiency: 99%  
 Battery Empty Voltage: 48V

Time	Watts	SOC	GridCharge
1:00AM	1000*Batts	40%	
5:00AM	1000*Batts	40%	
9:00AM	1000*Batts	40%	
1:00PM	1000*Batts	40%	
5:00PM	1000*Batts	40%	
9:00PM	1000*Batts	40%	

These settings will charge the batteries off solar only.  
 Discharge the batteries down to a maximum of 40% full.

Limited To Home mode will not sell to the grid from the batteries (only the home will use battery power).

**Blue Ion 2.0 Battery**

Batt Capacity: 40Ah x #Parallel\_Batteries  
 (4 Parallel = 160Ah, 6 = 240Ah, 8 = 320Ah)  
 Max A Charge: 160A w/ 4 Batteries, 185A w/ 6+  
 Max A Discharge: 160A w/ 4 Batteries, 185A w/ 6+  
 Max A Grid Charge: 160A w/ 4 Batteries, 185A w/ 6+  
 TEMPCO: 0mV/C/Cell  
 BMS Lithium Batt: 03  
 Float V: 55.2V  
 Absorption V: 55.2V  
 Equalization V: 55.2V  
 Equalization Days: 30  
 Equalization Duration: 1 Hours (tops off battery)  
 Recommended Shutdown V / Percentage: 47.0V & 20%  
 Recommended Low Batt V / Percentage: 49.0V & 30%  
 Recommended Restart V / Percentage: 52.0V & 40%  
 Battery Resistance: 5mOhms  
 Battery Charge Efficiency: 99%  
 Battery Empty Voltage: 46V

Time	Watts	SOC	GridCharge
1:00AM	8000*Par_Batts	40%	
5:00AM	8000*Par_Batts	40%	
9:00AM	8000*Par_Batts	40%	
1:00PM	8000*Par_Batts	40%	
4:00PM	8000*Par_Batts	40%	
9:00PM	8000*Par_Batts	40%	

These settings will charge the batteries off solar only.  
 Discharge the batteries down to a maximum of 40% full.

Limited To Home mode will not sell to the grid from the batteries (only the home will use battery power). The 100% time slot is to ensure that the batteries are properly cycled each day.

**Dyness B4850 Battery Module**

Batt Capacity: 50Ah x #Parallel\_Batteries  
 Max A Charge: 50A (25A for life) x #Parallel\_Batteries  
 Max A Discharge: 50A x #Parallel\_Batteries  
 Max A Grid Charge: 50A x #Parallel\_Batteries  
 TEMPCO: 0mV/C/Cell  
 BMS Lithium Batt: 01  
 Float V: 53.8V  
 Absorption V: 54.0V  
 Equalization V: 54.0V  
 Equalization Days: 30  
 Equalization Duration: 1 Hours (tops off battery)  
 Recommended Shutdown V / Percentage: 47V & 20%  
 Recommended Low Batt V / Percentage: 48V & 30%  
 Recommended Restart V / Percentage: 49V & 40%  
 Battery Resistance: 5mOhms  
 Battery Charge Efficiency: 99%  
 Battery Empty Voltage: 46V

Time	Watts	SOC	GridCharge
1:00AM	2400*Par_Batts	40%	
5:00AM	2400*Par_Batts	40%	
9:00AM	2400*Par_Batts	40%	
1:00PM	2400*Par_Batts	40%	
5:00PM	2400*Par_Batts	40%	
9:00PM	2400*Par_Batts	40%	

These settings will charge the batteries off solar only.  
 Discharge the batteries down to a maximum of 40% full.

Limited To Home mode will not sell to the grid from the batteries (only the home will use battery power).



# Wire Gauge Guide (Copper)

**PV input: 10AWG**

**Grid input: 6-4AWG**

**Gen input: 6-4AWG**

**Load output: 6-4AWG**

**All Sensors: 20-24AWG**

**Battery input: 2/0-4/0AWG (3/8" Lugs)**

15.875mm (5/8in)

23.813mm (15/16in)

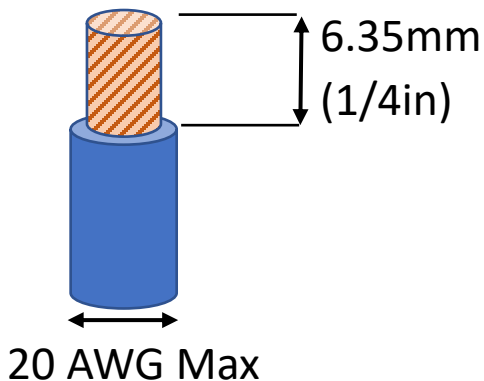
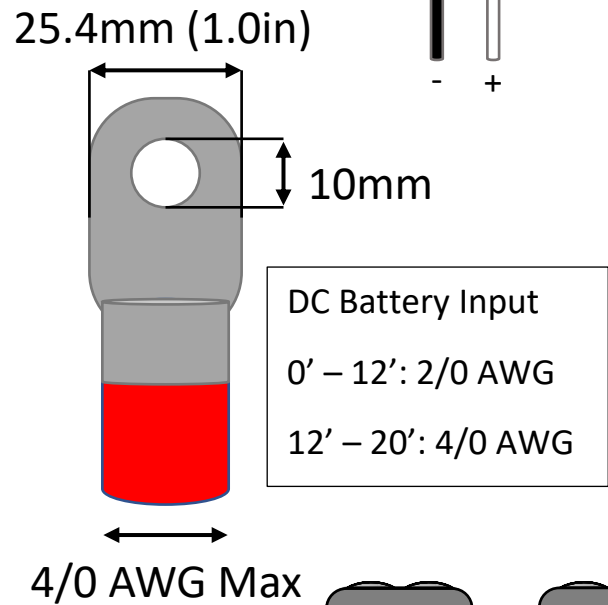
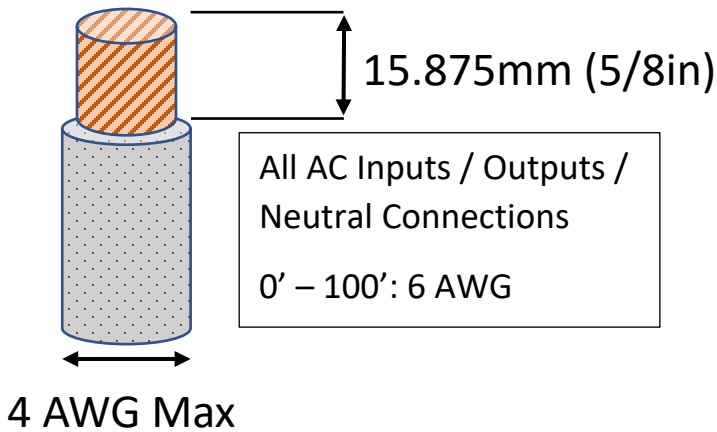
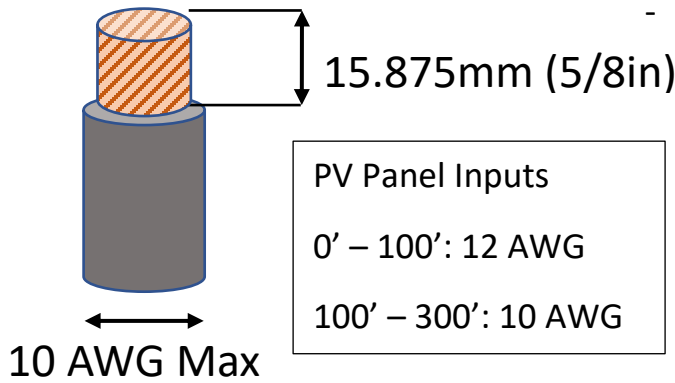
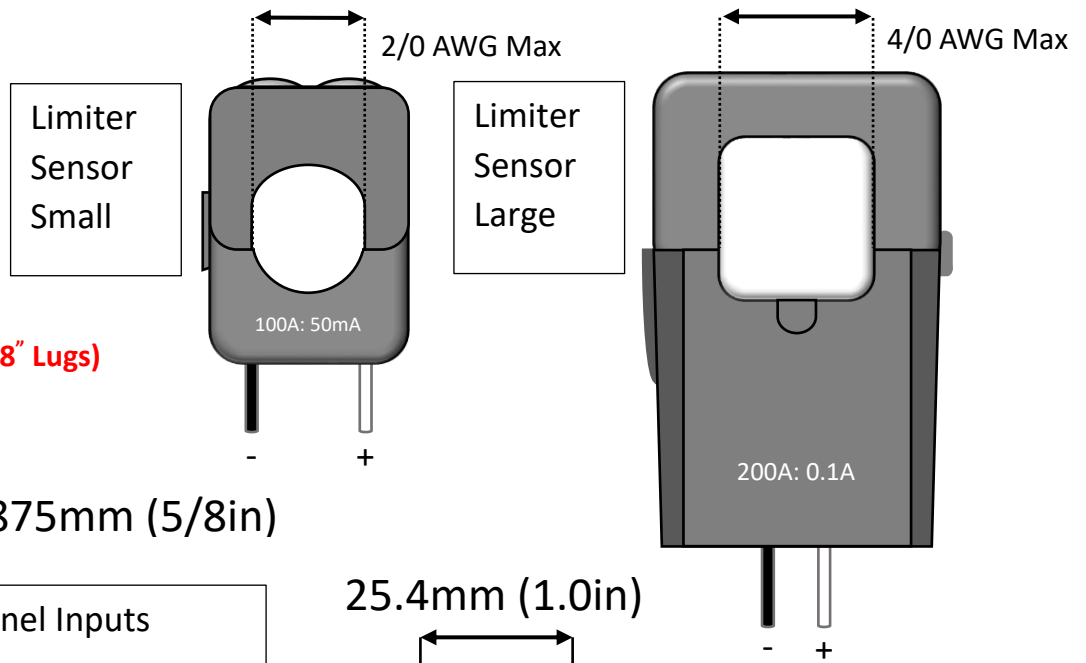

**All Sensor Inputs**  
 0' - 100': 24 AWG  
 100' - 400': 23 AWG CAT 6  
 Extensions for Limiter Sensors  
 must be twisted pair  
**(Shielded CAT6 Recommended)**

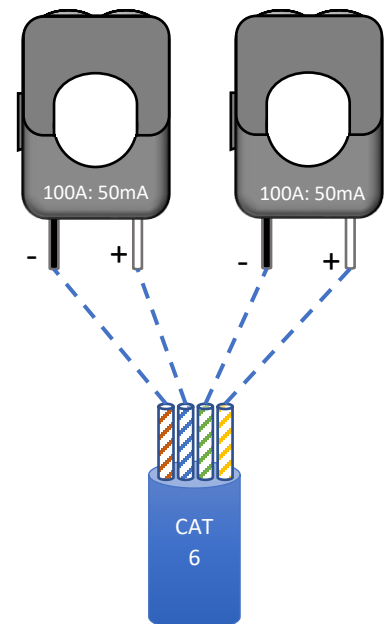

# Compatibility Reference Guide

(This list is for reference only and is not exhaustive)

- Rapid Shutdown:
  - String Level
    - Midnite MNLSOB-R1-600
  - Module Level
    - TIGO TS4-A-O
    - TIGO TS4-A-F
    - TIGO TS4-O
    - TIGO TS4-O-DUO
  - Disconnect / Transfer Switches
    - 200A Non-Fused Transfer Switch Model # TC10324R (GE)
    - 200A Fused Transfer Switch Model #DG224NRK (Eaton)
  - PV Fuses
    - 15A PV MC4 in-line fuse holder (ZOOKOTO or DPJ)

## Sol-Ark 8k Torque Values Application Note

Load Breaker	26.5 IN Lbs	3 NM
Grid Breaker	26.5 IN Lbs	3 NM
Gen Breaker	26.5 IN Lbs	3 NM
Neutral / Ground Busbars	26.5 IN Lbs	3 NM
Cover Screws	26.5 IN Lbs	3 NM
Battery Connection	480 IN Lbs	54 NM

# MODBUS/RJ45 Application Note

**Use the information below at your own risk, any damage cause by the improper use of the communications protocols will not be cover by warranty.**

## MODBUS

Pin 1 or 8 is RS485-B (Data -)  
Pin 2 or 7 is RS485-A (Data +)  
Pin 3 or 6 is GND  
Baud 9600  
8bits data  
One stop bit, no parity  
Does not require termination

## CANBUS

Pin 2 is ground  
Pin 4 is CAN High  
Pin 5 is CAN Low

If you set Lithium batt = 03, Blue Ion and EGauge (MODBUS)  
If you set Lithium batt = 02, Discover Lynk (CANBUS)  
If you set Lithium batt = 01, you get a response for batt communication.  
If you set Lithium batt = 00, the inverter is a slave and external device is the master.

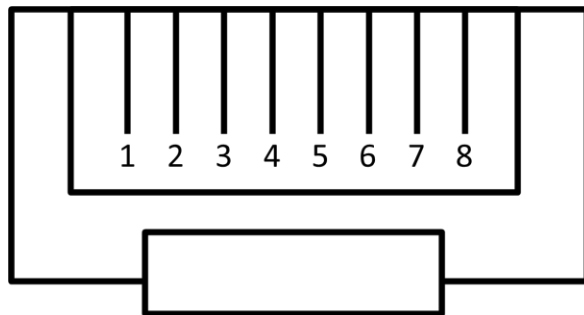

End View

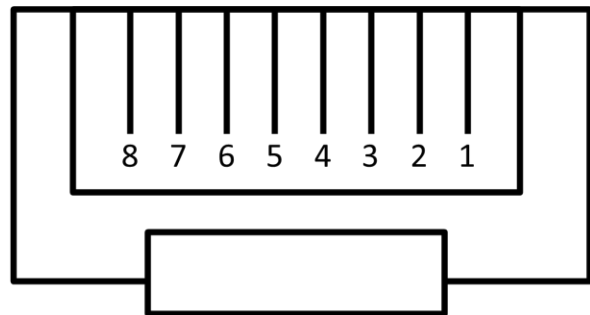

Looking Into Connector

Diagram 1

## Sol-Ark 8K Standard Wire Diagram 120V/240V

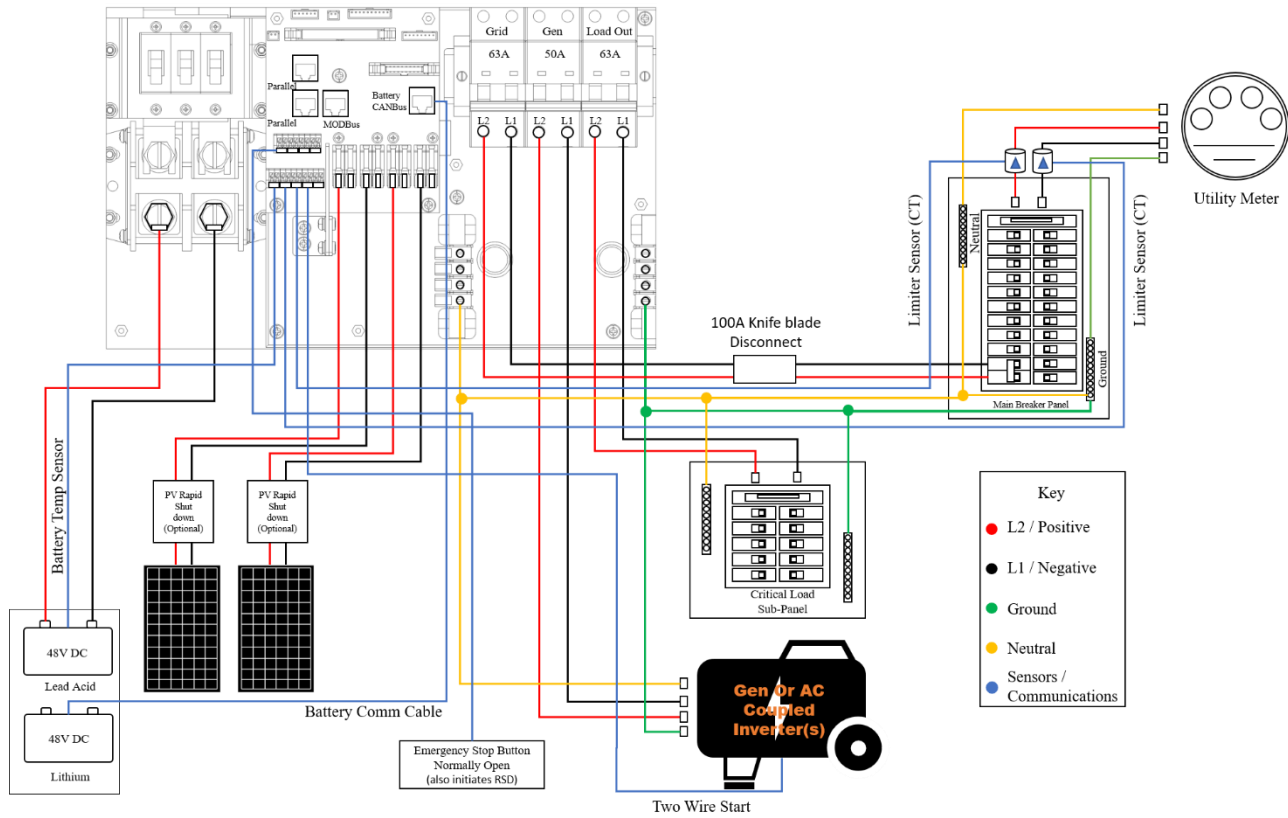
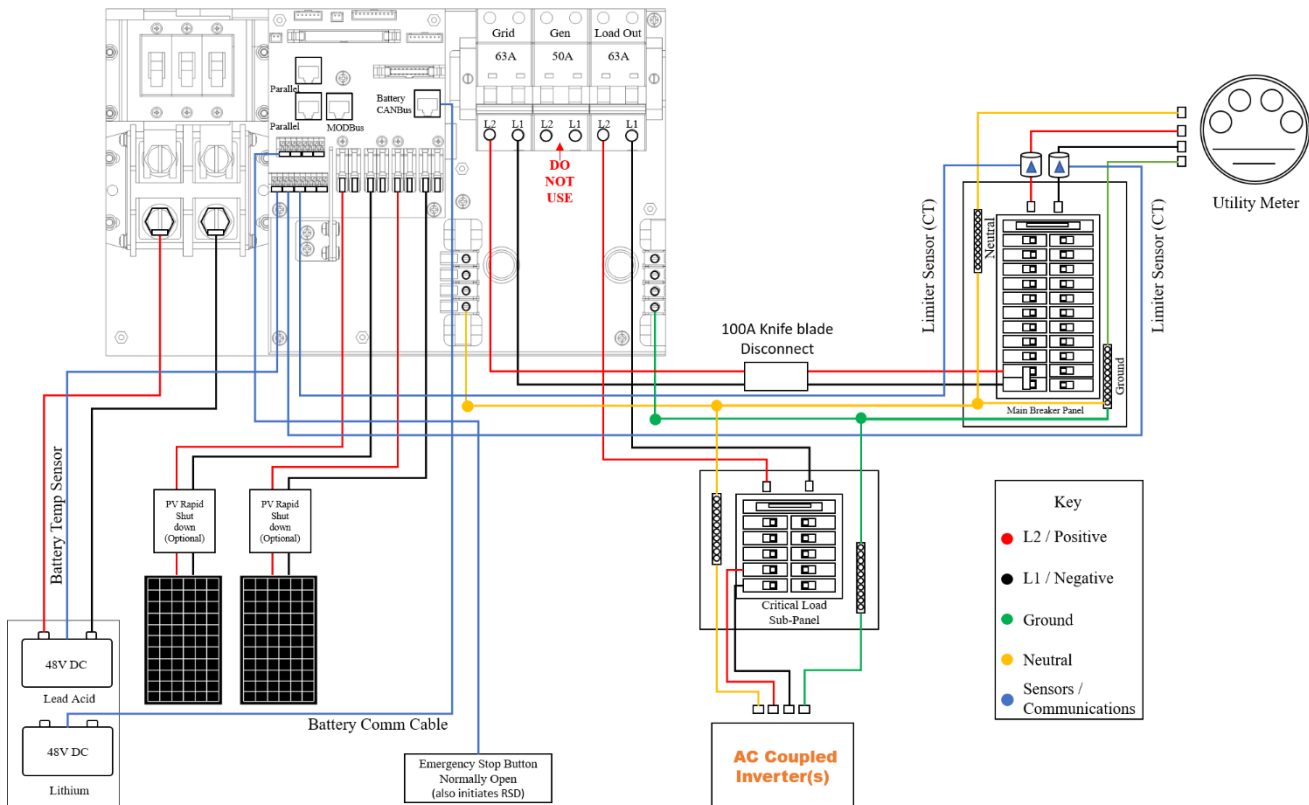

Diagram 2

## Sol-Ark 8K Load Side AC Coupled Wire Diagram 120V/240V



Sol-Ark 8K Whole Home Generator Wire Diagram 120V/240V

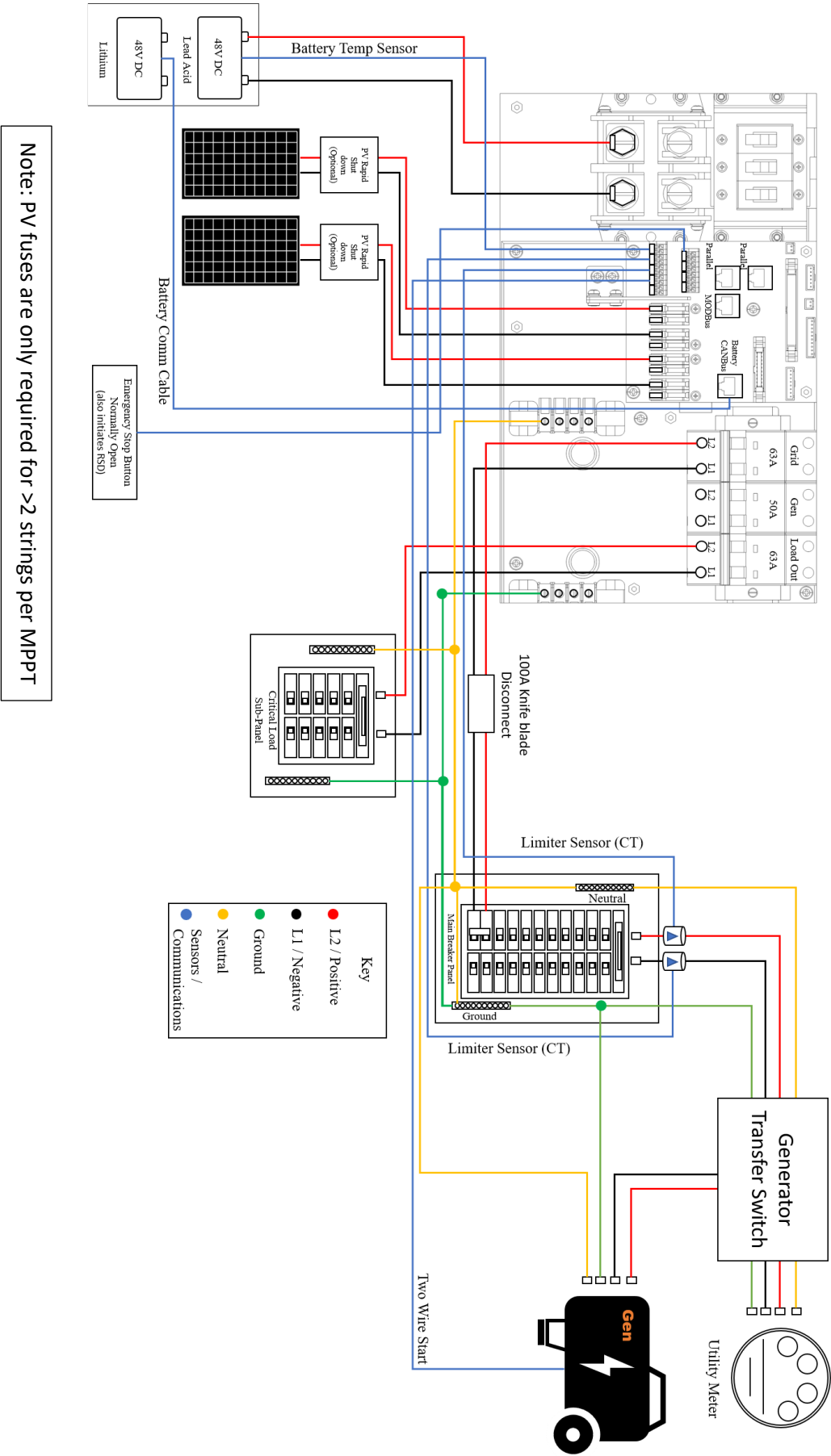
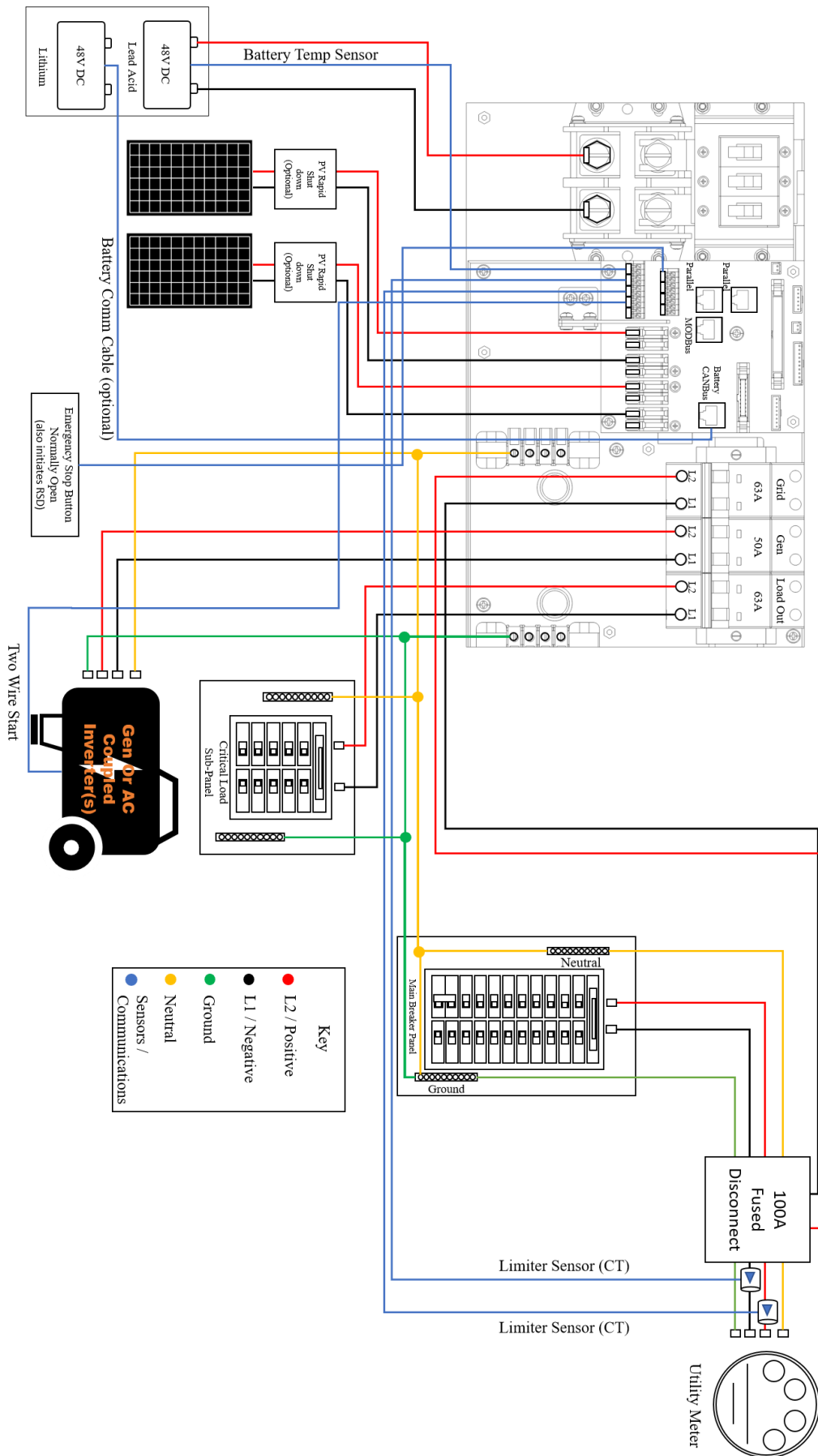

Diagram 3

# Sol-Ark 8K Line Side Tap Wire Diagram 120V/240V



Note: PV fuses are only required for >2 strings per MPPT

Diagram 2

# Sol-Ark 8k Install Operational Verification Checklist Questionnaire

**For installer to complete after system is operational. Purpose is to protect installer, homeowner, and inverter.**

1. Is the 8k installed in a location where the **LCD is protected from direct sunlight** and has 6" clearance left and right for cooling (12" between systems)? **Y/N**
2. Are all the battery lugs tightened? **Y/N**
3. 8k should be connected to Grid, 8k 63A load/Grid breakers on, batteries connected, PV input on and ON button on. With the inverter running the critical loads panel and Grid connected:
  - a. Did any breakers trip? **Y/N**
  - b. Did inverter overload? **Y/N**
4. If you have problems, please take pictures of these and email to: support@ Sol-Ark.com
  - a. **Battery icon screen, showing detailed voltages (the screen shown below)**
  - b. **Sol-Ark 8k with batteries and of user wiring area**
5. Load and solar test
  - a. Press the battery icon for the detailed voltages screen.
  - b. Is batt temp sensor working? **Y/N**
  - c. Turn on many loads for the critical circuits. Are solar panels producing enough power to match the load (provided there is enough sun)? **Y/N**
  - d. Program Full Grid sell mode. If there are enough panels and sun or light loads in the entire house, the Grid HM measurements will be negative on both L1/L2. Are they negative (solar selling back to grid)? **Y/N**
  - e. Program limited power to home mode. The Grid HM sensors will be near zero or slightly positive. Are they both near zero and cancelling out the whole home power? **Y/N**
  - f. You have verified the limit sensors are correctly installed. An auto learn function corrects any mistakes in CT limiter wiring (provided you have batteries and in 120/240V). Program in the correct Grid mode the customer will use.
6. Did you program the correct Ah for battery bank and max Amps charge/discharge? **Y/N**
7. Did you program the correct battery charge voltages for your battery type? **Y/N**
8. **Turn off the AC breaker so 8k is operating in off grid mode for several minutes.** Are appliances still powered? **Y/N**
9. **Turn off PV input, running only on batteries for several minutes.** Are appliances still powered? **Y/N**
10. Turn on PV input and AC Grid inputs.
11. Did you setup Wi-Fi plug to the customer's internet? **Y/N**
12. Absolutely important for software updates. Did you help customer register system on Monitoring App? **Y/N**
13. Does customer have a standby generator or small portable generator? **Y/N**
  - a. Did you turn off UL1741/IEEE1547 (use General Standard) and reprogram grid freq range to 53-65Hz? **Y/N**
  - b. If small gas generator using Gen inputs, did you enable Gen charging and properly set charge current? **Y/N**
14. If EMP protected, did you install EMP Suppressors on critical appliance cords? **Y/N**

\_\_\_\_\_  
Installer Name

\_\_\_\_\_  
Installer Signature

\_\_\_\_\_  
Date

\_\_\_\_\_  
Customer Name

\_\_\_\_\_  
Customer Signature

\_\_\_\_\_  
Date

## Limited Warranty: Sol-Ark 8k Hybrid Inverter

5-Year Limited Warranty for SOL-ARK (Portable Solar LLC) Products. Sol-Ark provides a Five-year (5) limited warranty ("Warranty") against defects in materials and workmanship for its Sol-Ark products ("Product"). The term of this Warranty begins on the Product(s) initial purchase date, or the date of receipt of the Product(s) by the end user, whichever is later. This must be indicated on the invoice, bill of sale from your installer. This Warranty applies to the original Sol-Ark Product purchaser and is transferable only if the Product remains installed in the original use location. Please call Sol-Ark to let us know if you are selling your home and give us name and contact of the new owner.

The warranty does not apply to any Product or Product part that has been modified or damaged by the following:

- ❖ Installation or Removal (examples: wrong voltage batteries, connecting batteries backwards, damage due to water/rain to electronics, preventable damage to solar wires.)
- ❖ Alteration or Disassembly
- ❖ Normal Wear and Tear
- ❖ Accident or Abuse
- ❖ Unauthorized Firmware updates/software updates or alterations to the software code
- ❖ Corrosion
- ❖ Lightning: unless using EMP hardened system, then Portable Solar will repair product
- ❖ Repair or service provided by an unauthorized repair facility
- ❖ Operation or installation contrary to manufacturer product instructions
- ❖ Fire, Floods or Acts of Nature
- ❖ Shipping or Transportation
- ❖ Incidental or consequential damage caused by other components of the power system
- ❖ Any product whose serial number has been altered, defaced or removed
- ❖ Any other event not foreseeable by Portable Solar, LLC

Sol-Ark (Portable Solar LLC) liability for any defective Product, or any Product part, shall be limited to the repair or replacement of the Product, at Portable Solar LLC discretion. Sol-Ark does not warrant or guarantee workmanship performed by any person or firm installing its Products. This Warranty does not cover the costs of installation, removal, shipping (except as described below), or reinstallation of Products or parts of Products. LCD screen and fans are covered for 5 years from date of purchase.

THIS LIMITED WARRANTY IS THE EXCLUSIVE WARRANTY APPLICABLE TO SOL-ARK (PORTABLE SOLAR LLC) PRODUCTS. SOL-ARK EXPRESSLY DISCLAIMS ANY OTHER EXPRESS OR IMPLIED WARRANTIES OF ITS PRODUCTS. SOL-ARK ALSO EXPRESSLY LIMITS ITS LIABILITY IN THE EVENT OF A PRODUCT DEFECT TO REPAIR OR REPLACEMENT IN ACCORDANCE WITH THE TERMS OF THIS LIMITED WARRANTY AND EXCLUDES ALL LIABILITY FOR INCIDENTAL OR CONSEQUENTIAL DAMAGES, INCLUDING WITHOUT LIMITATION ANY LIABILITY FOR PRODUCTS NOT BEING AVAILABLE FOR USE OR LOST REVENUES OR PROFITS, EVEN IF IT IS MADE AWARE OF SUCH POTENTIAL DAMAGES.

**Return Policy - No returns will be accepted without prior authorization** and must include the Return Material Authorization (RMA) number. Please call and talk to one of our engineers to obtain this number at 972-575-8875.

**Return Material Authorization (RMA) A request for an RMA number requires all of the following information:** 1. Product model and serial number; 2. Proof-of-purchase in the form of a copy of the original Product purchase invoice or receipt confirming the Product model number and serial number; 3. Description of the problem; 4. Validation of problem by Technical Support, and 5. Shipping address for the repaired or replacement equipment. Upon receiving this information, the Sol-Ark representative can issue an RMA number.

Any product that is returned must be brand new, in excellent condition and packaged in the original manufacturer's carton with all corresponding hardware and documentation. Returns must be shipped with prepaid freight and insured via the carrier of your choice to arrive back at Portable Solar within 30 days of your initial delivery or pick-up. **Shipping charges will not be refunded.**

All returns are subject to a 35% restocking fee. **No returns will be accepted beyond 30 days of original delivery.** The value and cost of replacing any items missing (e.g. parts, manuals, etc.) will be deducted from the refund. If you have any questions regarding our return policy, please email us at [sales@sol-ark.com](mailto:sales@sol-ark.com) or call us at the number above during regular (M-F) business hours.

**Sol-Ark 8k Install Operational Verification Checklist Questionnaire must be filled out, signed, and dated to secure full warranty coverage.**